

Environment and Social Screening Report

November 2018

"Construction of Additional Class Room Block
for Govt. Degree College, Bijbhehara-
Anantnag, Kashmir"

(Jhelum &Tawi Flood Recovery Project)

Prepared by PW (R&B) Department, Government of Jammu & Kashmir, for
the World Bank

EXECUTIVE SUMMARY

The devastating deluge of September 2014 had enormous negative impact on economic aspects of the state and massive infrastructure damages in which capital city Srinagar was most affected. In response, a mission of the World Bank visited the state during February 1-6, 2015 in order to produce a rapid multi-sectoral assessment report of the damages and needs. The RDNA estimates the total damages and loss caused by floods at about INR 211,975 million (US\$ 3,550.45), most of it to housing, livelihoods, and roads and bridges, which combined represented more than 70% of the damages in terms of value. Public service infrastructure and equipment of hospitals and education centres were also severely damaged and are still not fully operational. Based on the RDNA results and discussions with the GOJ&K, the "Jhelum and Tawi Flood Disaster Recovery Project (JTFRP)" will focus on restoring critical infrastructure using international best practice on resilient infrastructure. One of the sectors badly hit during the floods was education (school/college), the restorations of which have been included in the Component-1 of the World Bank funded JTFRP.

The Govt. Degree College Bijbehara has more than **3200** enrolled students. These students are accommodated in only 07 permanent and 07 makeshift class rooms made of pre-fabricated material. The students have to face a lot of problems as the class rooms are overcrowded. The institution is in its infancy and the detailed master plan required for establishment of a good & completed educational institute has been drafted.

Under the Component-1 an additional 3 storeyed class room block having twelve (12) class rooms, 6 (six) staff rooms with 6 (six) wash rooms with a stilt floor, proposed for under "Jhelum and Tawi Flood Recovery Project".

Sub-projects under "Jhelum and Tawi Flood Recovery Project (JTFRP)" have a prior requirement of screening which is based on three categories; viz., nature of the project, size of the project and location of the project that is sensitive area criteria. The objective of Environment and social screening is to identify the potentially significant environmental/social issues related with sub-project at an early stage for detailed Environmental and Social impact assessment.

Public consultations were undertaken during the site visits to the sub- project on 10-07-2018. Stakeholders of the College i.e. teachers, people from administration and students particularly female studying or working within the college were informed about the proposed sub-project and their views were obtained.

The screening study reveals that there are no adverse social impacts of the proposed sub-project and it does not involve any kind of land acquisition. The sub-project only involves construction of new classroom block on available government land in college premises.

1.0. INTRODUCTION

1.1. Project background

In September 2014, J&K experienced torrential monsoon rains in the region causing major floods and landslides. The continuous spell of rains from September 2-6, 2014, caused Jhelum, Chenab Rivers and many other streams/tributaries to flow above the danger mark. The Jhelum River breached its banks flooding many low-lying areas in Kashmir. In many districts, the rainfall exceeded the normal by over 600%. The Indian Meteorological Department (IMD) records precipitation above 244.4 mm as extremely heavy rainfall, and J&K received 558 mm of rain in the June- September period, as against the normal 477.4 mm. For

example, the district of Qazigund recorded over 550 mm of rainfall in 6 days as against a historic normal of 6.2 mm over the same period.

Due to the unprecedented heavy rainfall the catchment areas particularly the low lying was flooded for more than two weeks. Some areas in urban Srinagar stayed flooded for 28 days. Water levels were as high as 27 feet in many parts of Srinagar. The areas from the main tributaries of river Jhelum vis-à-vis Brengi nallah, Vishav nallah, Lider nallah and Sandran nallah started overflowing due to the heavy rainfall causing water levels in Jhelum river to rise. Subsequently, the discharge of the river Suran was 200 thousand cusecs as against an average of 50 thousand cusecs. With the excessive discharge of water, the river Suran affected the basin areas and also took a different course at various locations causing damages to the surrounding villages in the catchment area. Water levels also increased in the rivers of Chenab and Tawi, both of which were flowing above normal levels. Due to the rivers overflowing nearly 20 districts of the State were impacted.

A Joint team led by the Department of Economic Affairs (DEA), GoI, with representation from the World Bank visited J&K on October 21, 2014. Subsequently, GoI has sent a request to the World Bank on January 5, 2015 to field a Joint Rapid Damage and Needs Assessment (RDNA) Mission within the State. In response, a mission of the World Bank visited the state during February 1-6, 2015 in order to produce a rapid multi-sectoral assessment report of the damages and needs. The RDNA estimates the total damages and loss caused by floods at about INR 211,975 million (US\$ 3,550.45), most of it to housing, livelihoods, and roads and bridges, which combined represented more than 70% of the damages in terms of value. Public service infrastructure and

equipment of hospitals and education centres were also severely damaged and are still not fully operational.

Based on the RDNA results, restoration works underway, and discussions with the GoJ&K, the project will focus on restoring critical infrastructure using international best practice on resilient infrastructure. Given the state's vulnerability to both floods and earthquakes, the infrastructure will be designed with upgraded resilient features, and will include contingency planning for future disaster events. Therefore, the project aims at both restoring essential services disrupted by the floods and improving the design standard and practices in the state to increase resilience.

The project is comprised of the following seven components:

- i. Reconstruction and strengthening of critical infrastructure (US\$60 million)
- ii. Reconstruction of roads and bridges (US\$80 million)
- iii. Restoration of urban flood management infrastructure (US\$50 million)
- iv. Strengthening and restoration of livelihoods (US\$15 million)
- v. Strengthening disaster risk management capacity (US\$25 million)
- vi. Contingent Emergency Response (US\$0 million)
- vii. Implementation Support (US\$20 million)

1.2 Project Development Objective

The Project Development Objective (PDO) is to support the recovery and increase disaster resilience in targeted areas of the state, and increase the capacity of the State entities to respond promptly and effectively to an eligible crisis or emergency.

1.3 Sub-project Background:

The Component-1 of the project (JTFRP) envisages the construction/reconstruction and strengthening of critical infrastructure severely affected by the floods in September, 2014 viz., education buildings, hospitals, fire stations and other important public assets. It will include the restoration of partially damaged structures and the reconstruction of fully damaged structures, including equipment and furniture. Assessments will be carried out to determine the extent of structural integrity and retrofitting/reconstruction needs. For colleges/schools, the reconstruction will be focused on replacement of damaged buildings. The component will also finance the repair and reconstruction of damaged hospitals, higher education, fire station, and other public buildings, including the procurement of equipment/furniture, etc.

1.4 Sub-project Description

Bijbehara town is also known as "Chinar Town" because of two Chinar gardens (PaadshaahiBagh and Darashukoh Garden) which are known for their Chinars (*Platanusorientalis*) trees. The town is near the oldest Chinar tree in the state, which is about 9 kilometers from the Anantnag town ship and 45 km from the summer capital, Srinagar.

The Govt. Degree College Bijbehara is located at 33°48'04"N and 75°06'53"E. The college is situated in Bijbehara, in Anantnag district of Jammu and Kashmir. It is located at a distance of about 50 km from state summer capital Srinagar and 10 km from district headquarter Anantnag. Degree College Bijbehara was established in the year 2005. It started its operation from the year 2006. It was established during the chief-minister ship of Mufti Mohammad Sayed under Prime Minister of India's Reconstruction Plan. The college started its operations with only

22 students and now it has more than 3200 student. **(Appendix-D)**.

Presently, there is only one existing building block, housing seven (7) lecture halls with principal office, auditorium, rooms for department of chemistry, Computer Applications, labs for Botany, Zoology, Chemistry, and Examination Halls, Washroom.

The "Construction of Additional Classroom Block at Govt. Degree College Bijbehara, is proposed under World Bank funded "Jhelum Tawi Flood Recovery Project". The design of the Administrative block has taken into consideration the seismicity of the region and other factors. Planning principles and design considerations have also been reviewed and incorporated into the site planning process. The proposed infrastructure shall have an additional class room block 3 storey and a stilt floor with twelve (12) class rooms, 6 (six) staff rooms with 6 (six) wash room block proposed for smooth functioning of Educational Activities

Design features;

It has been proposed to construct Stilt + G + 2 RCC framed structure with the following accommodation:-

S.NO	FLOOR	ACCOMODATION TYPE	NUMBER	SIZE
1	LEVEL 01	Lecture Halls with seat tiers of RCC	04	9.22m x 9.44m
.		Staff room with two attached washroom & a Pantry	01	3.87m x 5.7m 2.14m x 1.5m
		Toilet Block for Males	01	3.87m x 7.1m
		Toilet Block for Females	01	3.87m x 7.1m
		One Specially Abled Toilet & Utility Room	01	2.14m x 1.8m each

Jhelum & Tawi Flood Recovery Project

		Generator Room	01	3.17m x 4.06m
		Fuel Room Electric	01	1.82m x 2.35m,
		Panel Room	01	1.8m x 2.5m
		Store.	01	1.82m x 4.9m
		Stair Hall with Elevator & a Fire Exit.	01	
2.	LEVEL 02	Lecture Halls with seat tiers of RCC	04	9.22m x 9.44m
		Staff room with two attached washroom & a Pantry	01	3.87m x 5.7m 2.14m x 1.5m
		HOD Room with attached washroom & a Pantry	01	3.87m x 5.7m . 2.14m x 1.5m.
		Common Hall	01	6.9m x 9.5m.
		Toilet Block for Males	01	3.87m x 7.1m
		Toilet Block for Females	01	3.87m x 7.1m
		One Specially Abled Toilet & Utility Room	01	2.14m x 1.8m each
		Stair Hall with Elevator & a Fire Exit.	01	
3.	LEVEL 03	Lecture Halls with seat tiers of RCC	04	9.22m x 9.44m
		Staff room with two attached washroom & a	01	3.87m x 5.7m 2.14m x 1.5m

		Pantry		
		HOD Room with attached washroom & a Pantry	01	3.87m x 5.7m . 2.14m x 1.5m.
		Common Hall	01	6.9m x 9.5m.
		Toilet Block for Males	01	3.87m x 7.1m
		Toilet Block for Females	01	3.87m x 7.1m
		One Specially Abled Toilet & Utility Room	01	2.14m x 1.8m each
		Stair Hall with Elevator & a Fire Exit.	01	
4.	Attic Floor	Language Labs	02	9.40m x 5.6m
		Departmental Library additional space	01 01	26.3m x 5.7m • 5.3m x 6.9m.
		Stair Hall with Elevator & a Fire Exit.	01	

The buildings shall rest on RCC Raft / Pile foundation with plinth beams as per design. RCC Frame structure has been proposed with non load bearing panels of bricks/ hollow blocks (110 mm brick work and 200 mm hollow block) masonry in cement for the building. RCC slab shall be laid over and shall be provided with steel roof truss with colour coated CGI sheets in accordance with structural design. Wooden frames of designed section shall be provided for doors, /Windows and glazed/paneled shutters wood or equivalent shall be provided in accordance with the approved architectural design. The wood work shall be

painted / polished with paint of approved quality. The floor shall be of Kota/Terrazzo/ Vitrified Tiles/ Granite as per the norms freezed in CPWD cost index. All other areas including ceiling shall be cement plastered and finished with POP and emulsion paint of approved shade. The ceilings of classrooms shall be of gypsum board false ceiling. The toilets shall be provided with concealed sanitary and plumbing pipes/fittings with the requisite fixtures, chinaware etc.in accordance with the approved specifications.

Master Plan Showing Scope of Future Expansion

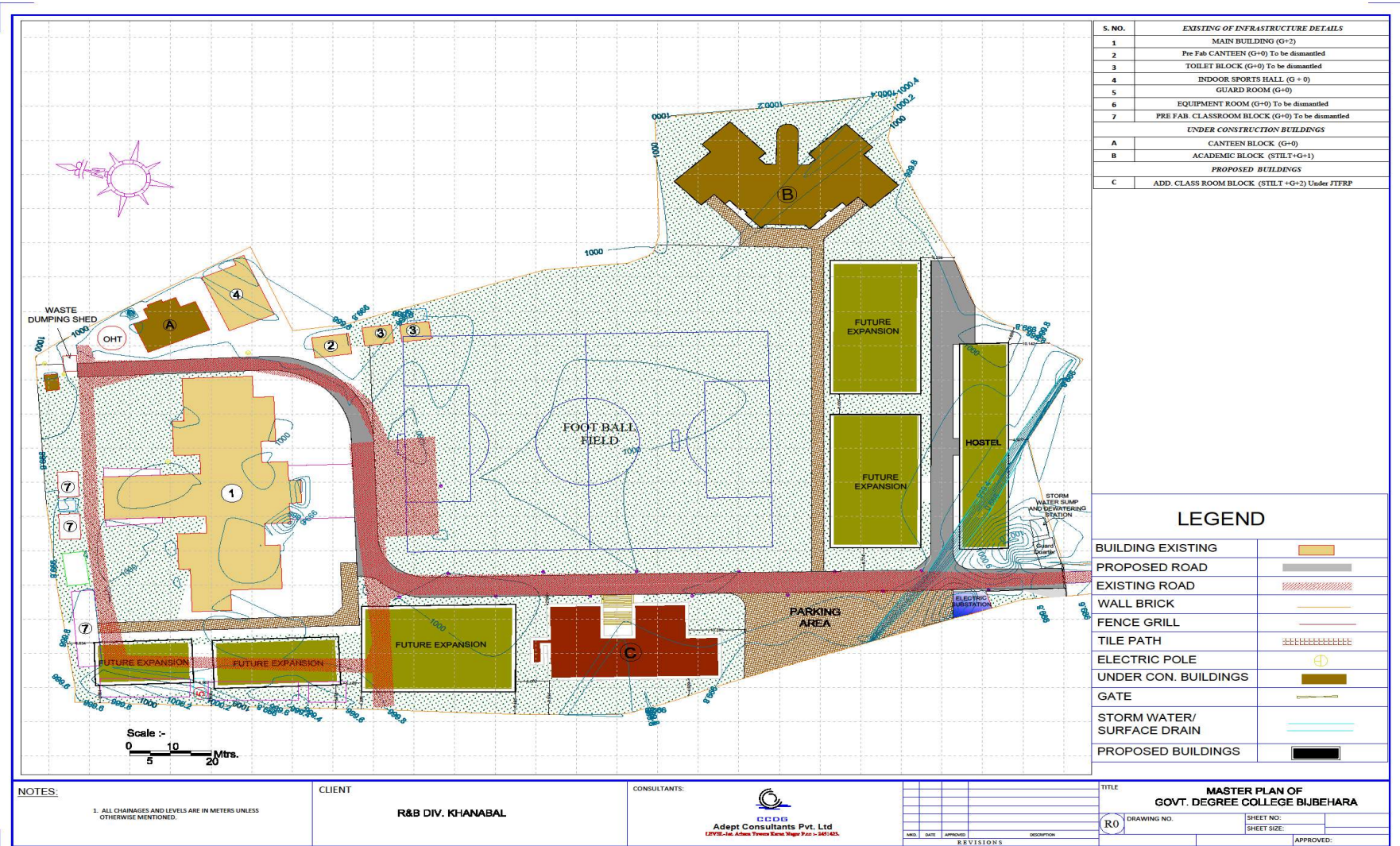

Environmental Screening Of GDC Bijbehara

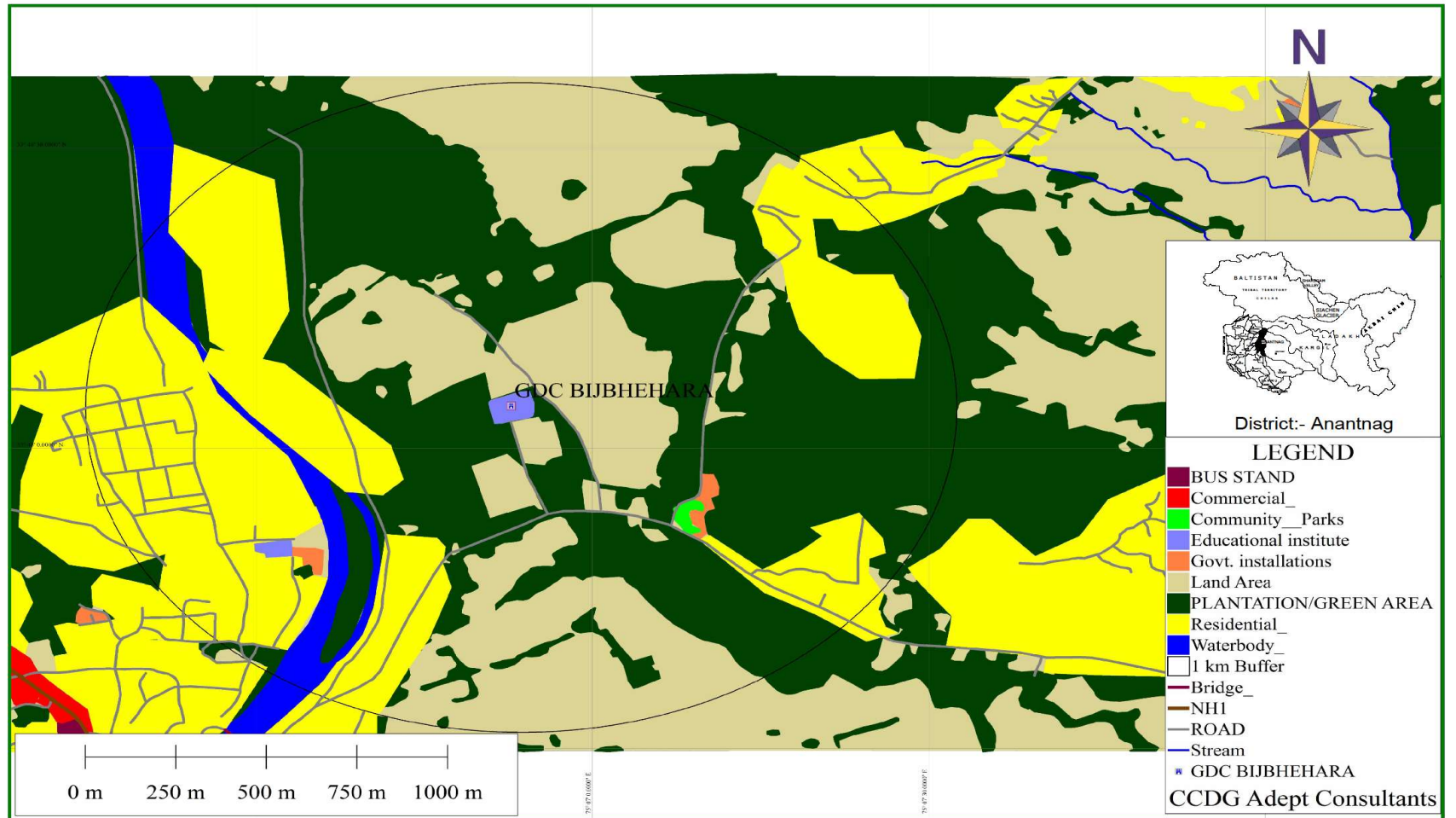

1.5. Objective of the Environmental and Social Screening

Sub-projects under "Jhelum and Tawi Flood Recovery Project" commonly known as JTFRP have a prior requirement of screening which is based on three categories; viz., nature of the project, size of the project and location of the project that is sensitive area criteria. Based on this assessment, sub-projects with potentially significant environmental/ social issues are identified at an early stage for detailed Environmental/ Social impacts assessment.

1.6. Methodology of Environment and Social Screening Study

The environment and social screening for the sub-project has been carried out at the site by making use of a Environment and Social Screening Checklist **(Appendix-A)** that contains the relevant questions for identification of anticipated environment and social impacts due to execution of the sub-project.

2.0. Environment and Social Issues

2.1 Environment Issues

It is anticipated that sub-project will have no adverse social and irreversible environmental impacts. A slight increase in local air pollution due to cutting and filling works and other associated construction activities is anticipated. This impact shall be temporary, site specific and reversible in nature. The proposed site is in the college premises and is the government land. There are no sensitive areas like specially protected areas or threatened or endangered endemic species in the project area. The execution of sub-project does not involve any tree cutting.

2.2. Social Issues

2.2.1. Availability of land

The proposed subproject does not involve land acquisition. The proposed subproject involves construction of new infrastructure facility on available government land. The revenue document pertaining to the land is annexed as **Appendix-B** and its translated version duly attested as **Appendix-C**.

2.2.3. Impact on Livelihood

No adverse impact on the livelihood of anyone envisaged as the construction is inside the college premises and on government land. Positive impacts in terms of employment opportunities anticipated as many skilled, semi-skilled and un-skilled personnel will get direct and indirect employment during construction phase. Wider, flow-on economic impacts will be experienced in other sectors of economy as a result of purchase of construction materials and the payment of wages and salaries.

Requirement of SIA/EIA

Hence, no further Environmental Impact Assessment (EIA)/ Social impact assessment (SIA) needs to be undertaken since social and environment findings during E&SSR preparation did not envisage any adverse social and irreversible significant environmental impacts in the sub-project area. However, Environmental and social Management Plan (ESMP) will provide specific actions deemed necessary to assist in mitigating the temporary environmental impacts, addressing grievances of people arising out of the sub-project related activities and labour management beside other requirements. ESMP will guide the environmentally-sound execution of the subproject, and ensure efficient lines of communication between the implementing agency, project management unit, contractors and people. The ESMPs will form part of the bid document and to be reviewed and updated during implementation as per requirements. The ESMP will be included in

the contractual clauses and will be made binding on the contracting firm.

3. Public Consultation

In compliance with the ESMF, public consultations were undertaken during the site visits in the sub- project areas on **10-07-2018**. Stakeholders (College administration, teachers, students particularly females studying or working within the college campus and people who are directly or indirectly involved with the sub-project) were informed about the proposed activities and their views were obtained (**Appendix-D**).

2.1 Issues discussed

- Need of the subproject.
- Current facilities.
- Project and its source of assistance i.e. World Bank. Its implementation/execution etc.
- Proposed proposal for sub-project
- Inconveniences during construction phase with academic activities.
- Study of Environment and Social Screening requirements and benefits and Concept of ESMP.
- Adverse environment impacts and mitigation measures during construction phase.
- Environmental and Social Policy of World Bank.
- Protection and conservation aspects of environmental attributes
- Proposed Grievance Redressal Mechanism for the sub-project.

3.2 Outcome and suggestions received from the Public Consultation

The following suggestions were received:

- Proper barricading of construction site during construction phase so that any untoward incident can be avoided in the college campus.
- That mitigation measures should be effective during construction phase.
- That those activities which cause major disturbances should be executed before and after college timing so that study should not be affected.
- Disclosure of proposed Grievance Redressal Mechanism.

PW (R&B) department as PIU/ implementing agency will ensure that the requisite environmental and social management measure shall be incorporated in ESMP and public consultation shall be a regular process during all stages of the sub -project to solve any issues arising out of the proposed works.

Appendix-A

Environment and Social Screening Form

Part A: General Information

1. Name of the sub-project	Construction of additional Class Rooms For Government Degree College at Bijbehara, Anantnag, Kashmir	
2. Type of proposed activity (tick the applicable option and provide details)		
▪ Road		
▪ Bridge		
▪ Fire Station		-
▪ Hospital/Health		
▪ Educational Institute	✓	Proposed New College
▪ Building for Livelihoods		
▪ Flood Infrastructure		
▪ Other Public Building		
▪ Any Other (Please		
3. Location of the proposed sub-project		
▪ Name of the Region	Kashmir (J&K State)	
▪ Name of the District	Anantnag	
▪ Name of the Block	Bijbehara	
▪ Name of the Settlement		
▪ Latitude	33° 48' 04'' N	
▪ Longitude	75° 06' 53'' N	
4a. Proposed Nature of Work (tick the applicable options)		
▪ Minor Repairs		
▪ Major Repairs/Rehabilitation		

▪ Upgrading/Major Improvement	
▪ Expansion of the facility	
▪ New Construction	✓
▪ Any Other	
4b. Size of the sub-project (approx. area in sq. mt/hac or length in mt/km, as relevant)	789 sq.m
4. Land Requirement (in hac./sq.mt.) required/ Available with the college authorities.	
▪ Total Requirement	
▪ Private Land	Not required
▪ Govt. Land	Available (Appendix-B&C)
▪ Forest Land	Not required
6. Implementing Agency Details (sub-project level)	
▪ Name of the Department /Agency	PW(R&B) Deptt.Kahmir
▪ Name of the contact person	Mr.Javeid Bukhari
▪ Designation	Ex. Engineer
▪ Contact Number	+91-9419006437
▪ E-mail Id	javeidbukhari@gmail.com
7. Screening Exercise Details	
▪ Date on which it was carried out	10-07-2018
▪ Name of the Person	Mr.KaiserRafiq
▪ Contact Number	8713927709 / 7006382221
▪ E-mail Id	rafiq.kaiser@yahoo.com

Part B (1): Environment Screening

Question	Yes	No	Details
1. Is the sub-project located in whole or part within 1 km of the following environmentally sensitive areas?			
a. Biosphere Reserve		No	
b. National Park		No	
c. Wildlife/Bird		No	
d. Wildlife/Bird Reserve		No	
e. Important Bird Areas (IBAs)		No	
f. Habitat of migratory birds		No	
g. Breeding/Foraging/Migratory route of Wild Animals (outside		No	
h. Area with threatened/rare/ endangered fauna		No	
i. Area with threatened/rare/ endangered flora		No	
j. Reserved/Protected Forest		No	
k. Other category of Forest		No	
l. Wetland		No	
m. Natural Lakes		No	
n. Rivers/Streams	Yes		Jhelum river is 1 km away from proposed Sub-project site.
o. Swamps/Mudflats		No	
p. Zoological Park		No	

q. Botanical Garden		No	
4. Is the sub-project located in whole or part within 500 mts. of any of the following sensitive features?			
a. World Heritage Sites		No	
b. Archaeological monuments/ sites (under ASI)		No	
c. Historic Places/Monuments/ Buildings/Other Assets (not listed under ASI list but considered)		No	
d. Religious Places (regionally or locally)		No	
e. Reservoirs/Dams		No	
f. Canals		No	
g. Public Water Supply Areas from Rivers/Surface Water		No	
4. What is the High Flood Level in the sub-project area?	34.70 Guage in feets, 115218 cusec discharge at Sangam.		
5. Is any scheduled/protected tree like Chinar, Mulberry or Deodar		No	
6. Is the sub-project located in a landslide/heavy erosion prone area or		No	
7. Is sub-project located in an area that faces water		No	

Part B (2) : Result/Outcome of Environmental Screening Exercise		
1.	Environment Impact Assessment Required	No
2.	Environment Clearance Required	No
3.	Forest land Clearance/Diversion	No
4.	Tree Cutting Permission Required	No
5.	ASI (Centre/State) Permission Required	No
6.	Permission from ULB/Local Body/Department Required	Yes Permission for building construction will be required from Town Area Committee
7.	Any other clearance/permission required	Yes Various Statutory clearances and NOC's / PUC's for establishment or operation of stone crushers, generators, vehicles etc shall be required to be obtained by the Contractor from the concerned authorities. Construction material will be procured only from permitted sites and licensed /authorized quarries/ borrow sites.

Part C (1): Social Screening

1. Does the sub-project activity require acquisition of land?			
Yes		No	✓
Give the following details:	Private Land (sqmts/hac.)		No
	Govt. Land (sqmts/hac.)		No
	Forest Land (sqmts/hac.)		No
2. Does the proposed sub-project activity result in demolition/removal of existing structures?			
Yes		No	✓
If so, give the following details:			
▪ Number of public structures/buildings		No	
▪ Number of common property resources (such as religious/cultural/ drinking water/wells/etc.)		-	
▪ Number of private structures (located on private or public land)		-	
3. Does the proposed project activity result in loss of crops/trees?			
Yes		No	✓
4. Does the proposed Project activity result in loss of direct livelihood/ employment?			
Yes		No	✓
5. Does the proposed activity result in loss of community forest/pastures on which nearby residents/local population are dependent?			

Yes		No	√
If yes, give the details of the extent of area to be lost (in acres/hac).			
6. Does the proposed Project activity affect scheduled tribe/caste communities?			
Yes		No	√

Part C (2): Result/Outcome of Social Screening Exercise

S.No.	Result/Outcome	Outcome
1.	Answer to all the questions is 'No' and only forest land is being acquired	NA
2.	Answer to any question is 'Yes' and the sub-project does not affect more than 200 people (i.e. either complete or partial loss of assets and/or livelihood)	No
3.	Answer to any question is 'Yes' and the sub-project affects more than 200 people (<i>i.e. either complete or partial loss of assets and/or livelihood</i>)	No

Outcome

The proposed sub-project will not have adverse social impact and significant environmental impact. Only Inconveniences to Staff, students and local citizens during construction phase envisaged and to address the same, ESMP will be implemented during construction.

No EIA and SIA required for the subproject site. However, the subproject would require preparation of ESMP.

Statutory Clearances/ No Objection Certificate:

Only Statutory clearances and NOC's / PUC's for establishment/operation of batching plant, stone crushers, generators, vehicles etc shall be required to be obtained by the Contractor

Appendix-B

Land ownership documents

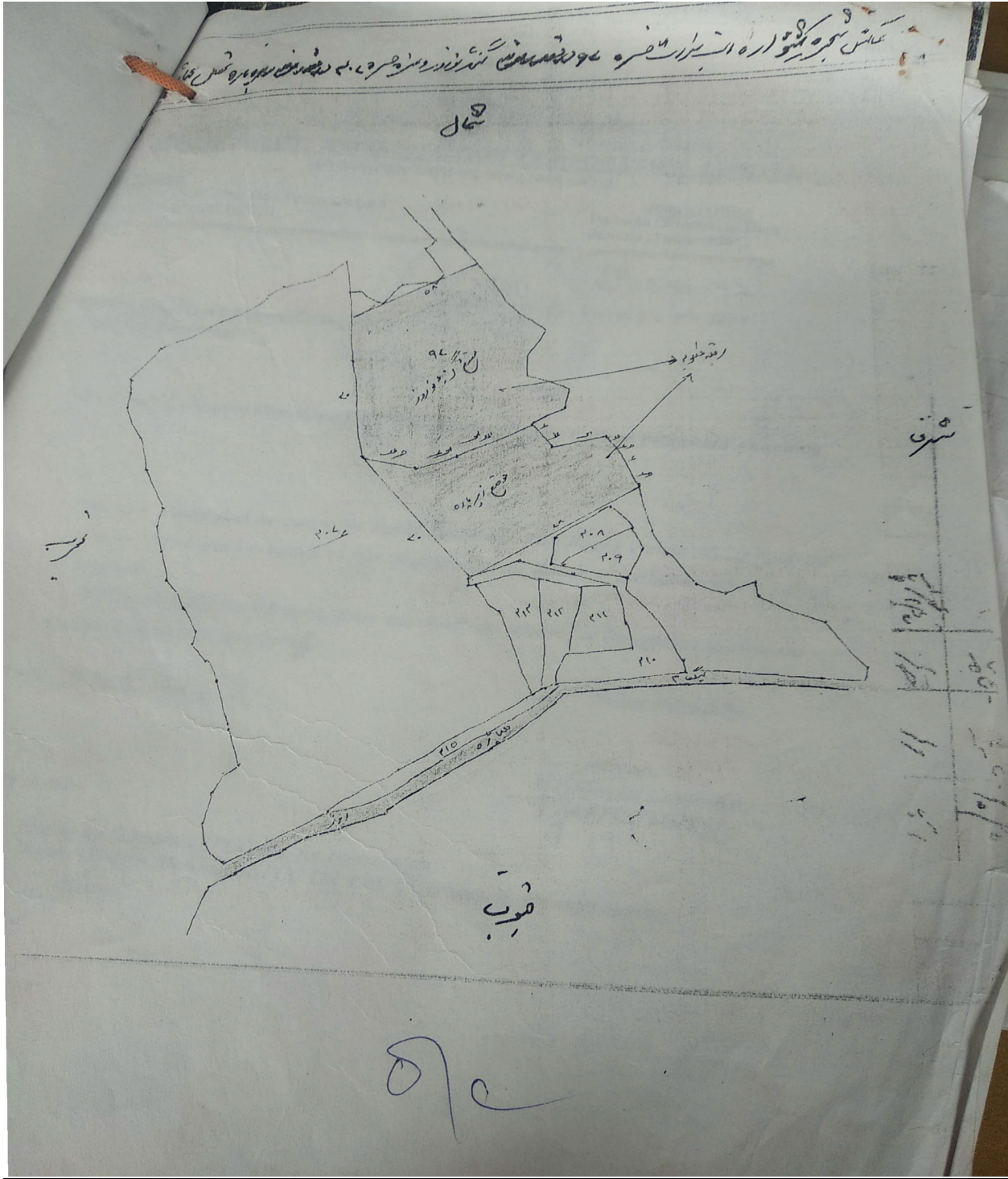

Translated copy of land document

ENGLISH TRANSLATION COPY OF
INTIKHAB KHASRA GIRDAWARI
DEGREE COLLEGE, ZIRPORA, BIJBEHARA
UNDER KHASRA NO. 97-MIN AND 407-MIN FOR REVENUE
VILLAGE STATE ZIRPORA, TEHSIL BIJBEHARA, DISTRICT ANANTNAG

(1)	(2)	(3)	(4)	(5)	(6)	(7)	(8)
Khasra No.	Name of Owner with Details	Name of Cultivator with Details	Area		Type of Land	Levy, etc.	Remarks
			Kanal	Marla			
407-min	State	Under possession of Youth Sports Council and Youth Services.	25	---	Banjri Qadeem	Min No	---
97-min	State	As per record.	35	15	Banjri Qadeem	Min No	---

NOTE:

- The duplicate has been issued along with Intikhab Jamabandi (revenue extracts)

Sd/- Patwari
Halqa Zirpora

ENGLISH TRANSLATION BY:

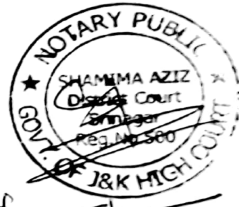
SC
 Translation Arrested
 on Dat- 10-06-2019

Appendix-D

List of staff members who participated the consultation

FACULTY/STUDENT/GENERAL INTERACTION/CONSULTATION ATTENDANCE SLIP

Sub-Project Name: Govt. Degree College Bhijbehara.





Date: 10-07-2017 Venue: GDC Bhijbehara.

S. No.	Name With Profession	Designation/Stream	Address/Phone	Signature
01.	Dr. Firdous Ahmad	Asstt. professor	GDC - Bhijbehara 9596056111	
02.	Mohd Rafiq	Asstt. Prof.	GDC - Bhijbehara 9736956110	
03	Mudasir majid	Asstt. prof.	GDC Bhijbehara 9797264612	
04.	Dr. S.M. Zuber	Asstt. Prof.	G.D.C. Bhijbehara 9018956647	
05.	Mr. Burhan Akhnd	Asstt. Prof.	G.D.C. Bhijbehara 9419017512	
06	Dr. Farooq Ahmad	Sr. Asstt. Prof.	9797772297	
07.	Dr. Mehraj Ahmad	Asstt. Professor	9906486978	

FACULTY/STUDENT/GENERAL INTERACTION/CONSULTATION ATTENDANCE SLIP

Sub-Project Name: Class Room Block GDC Bijbehara

Date: 10-07-2018 Venue: Govt Degree college Bijbehara

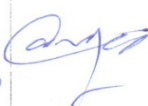
S. No.	Name With Profession	Designation/Stream	Address/Phone	Signature
1.	Dr. K. A. Wani	Assistant Professor	Wani GDC - Bijbehara 9682169453.	
2.	Musamml Jan	Assistant Professor Economics.	GDC - Bijbehara	
3.	Ruqayyah Shakeel	Assistant Professor Urdu.	GDC - Bijbehara	
4.	Kausar Fatima	Contractual Lecturer Statistics	GDC Bijbehara	
5.	Farwa Jabeen	Contractual Lecturer - in English	GDC Bijbehara	
9	Jahangeer Ahmad wani	Cont. Lecturer CEVS	GDC Bijbehara 9854388370	

List of participated students

FACULTY/STUDENT/GENERAL INTERACTION/CONSULTATION ATTENDANCE SLIP

Sub-Project Name: CDC, Bhijbehaya.

Date: 10-07-2017. Venue:

S. No.	Name With Profession	Designation/Stream/class	Address/Phone Roll- no / semester	Signature
1.	Zulabi Nisak	Student/Arts	1480 4 th	Zulabi
02.	Gulshana Akhter	Student/Arts	1430 4 th	g.s.
03.	Roomi Farooq	Student/Arts	1219 3 rd	Roomi
04.	Roomy Nazir	Student/Arts	1189 3 rd	Roomy
05.	Piloy Hassan	Student/Arts	1190 3 rd	Piloy
06.	Aarifa Hussain	Student/Arts	1421 3 rd Sem.	Aarifa
07.	Ubaida Yousf	Student/Arts	859 3 rd Sem.	Ubaida
08.	Iqra Farooq	Student/Arts	1201 3 rd sem	Iqra
09.	Nancy Nabi	Student/Arts	1275 3 rd sem	Nancy
10.	Ulfat Jan	Student/Arts	1377 3 rd sem	Ulfat
11.	Shoby Jan	Student/Arts	1349 4 th sem	Shoby
12.	Shaista Akhter	Student/Arts	1350 4 th Sem	Shaista
13.	Shaista Sabir	Student/Arts	1479 4 th Sem	Shaista
14.	Tabinda Manzoor	Student/Arts	596 4 th sem	Tabinda
15.	Bilqeesa Manzoor	Student/Arts	600 4 th Sem	Bilqeesa
16.	Masrat Jan	Student/Arts	636 4 th sem	Masrat
17.	Sabreena Akhter	Students/Arts	617 4 th Sa.	Sabreena
18.	Aasia Nazir	Student/Arts	598 4 th sem	Aasia
19.				
20.				
21.				

FACULTY/STUDENT/GENERAL INTERACTION/CONSULTATION ATTENDANCE SLIP

Sub-Project Name: GDC, Bhiybehara

Date: 10-07-2018 Venue: G.D.C Bhiybehara.

S. No.	Name With Profession	Designation/Stream / Roll	Address Address/Phone	Signature
	Rashid Ahmad Lone	90 / medical 3 rd sem	GDC, Bhiybehara	Rashid.
	Aabid Rashid	14 / DO	GDC-Bhiybehara	Aabid.
	MOLd IMRAN	126 / DO	GDC- Bih	Imran
	Muqtara Mushtaq	121 / DO	GDC. Bih.	Muqtara
	Aabid Abdullah	122 / DO	GDC. Bih.	Aabid
	Imtiyaz Ahmad Tali	124 / DO	GDC Bih	Imtiyaz
	Danish Bashir wani	91 / DO	GDC Bih	Danish
	Yasir Hameed Shah	32 medical IV sem	- DO -	Yasir
	Zubair Ahmad Lone	06 - DO -	- DO -	Zubair.
	Shahmawaz Abdullah	67 - DO -	- DO -	Shahmawaz
<u>Other Stake holder's</u>				
11	Mr. Mujeeb Nazir.	Canteen owner	GDC, Bhiybehara. 9596208593	Mujeeb

Appendix-E

Plate.1. Slides showing public consultation with different stakeholders of GDC, Bijbihara



Plate.2. consultation with male students



Plate.3.consultation with female students



Plate.4.existing infrastructure

