

Environment and Social Screening Report

March- 2019

Construction of Lecture Hall Block at Government College for Women, M.A. Road Srinagar, Jammu and Kashmir

(Jhelum &Tawi Flood Recovery Project)

Prepared by PW (R&B) Department, Government of Jammu & Kashmir, for the World Bank

EXECUTIVE SUMMARY

The devastating deluge of September 2014 had enormous negative impact on economic aspects of the state and massive infrastructure damages in which capital city Srinagar was most affected. In response, a mission of the World Bank visited the state during February 1-6, 2015 in order to produce a rapid multi-sectoral assessment report of the damages and needs. The RDNA estimates the total damages and loss caused by floods at about INR 211,975 million (US\$ 3,550.45), most of it to housing, livelihoods, and roads and bridges, which combined represented more than 70% of the damages in terms of value. Public service infrastructure and equipment of hospitals and education centres were also severely damaged and are still not fully operational.

Based on the RDNA results and discussions with the GOJ&K, the “Jhelum and Tawi Flood Recovery Project (JTFRP)” will focus on restoring critical infrastructure using international best practice on resilient infrastructure. One of the sectors badly hit during the floods was education (school/college), the restorations of which have been included in the Component-1 of the World Bank funded JTFRP.

Government College for Women M.A. Road was affected by the floods due to its low lying nature and proximity to two water bodies namely Fakhray Kashmir Stream and river Jhelum. During the floods of 2014 the college was inundated up to 12 feet from the plinth for more than 20 days. The result was suspension of academic activities for more than one month due to damages to infrastructure, laboratories, libraries etc. The old infrastructure of the college comprising of Geography and Music department was damaged beyond repair. Currently the college is facing problems due to shortage of lecture halls, staff rooms, washrooms etc.

As per the GAP report the number of lecture halls do not suffice the present student roll. The Lecture rooms in various buildings presently are inadequate and affect the teacher-learner process. In view of this it was decided to construct new Lecture hall block for the college under component 1 of Jhelum and Tawi Flood Recovery Project (JTFRP).

Subprojects under “Jhelum and Tawi Flood Recovery Project (JTFRP)” have a prior requirement of screening which is based on three categories; viz., nature of the project, size of the project and location of the project that is sensitive area criteria. The objective of Environment and social screening is to identify the potentially significant

environmental/ social issues of the sub-project at an early stage for detailed Environmental and Social impacts.

Public consultations were undertaken during the site visits in the sub- project areas on 24-03-2019 and 03-04-2019. Different stakeholders like local businessmen, teachers, people from administration, and students (particularly female studying or working within the college) were informed about the proposed sub-project and their views were obtained.

The screening study reveals that there are no significant environmental or social impacts of the proposed sub project. The construction of new Lecture hall block facility shall be undertaken on available land owned by the college (documental evidence in support as **Appendix-B** and translated copy dully attested as **Appendix-C**). The proposed project therefore does not involve any kind of land acquisition.

1.0. INTRODUCTION

1.1. Project background

In September 2014, J&K experienced torrential monsoon rains in the region causing major flooding and landslides. The continuous spell of rains from September 2-6, 2014, caused Jhelum and Chenab Rivers as well as many other streams/tributaries to flow above the danger mark. The Jhelum River also breached its banks flooding many low-lying areas in Kashmir, including the capital. In many districts, the rainfall exceeded the normal by over 600%. The Indian Meteorological Department (IMD) records precipitation above 244.4 mm as extremely heavy rainfall, and J&K received 558mm of rain in the June- September period, as against the normal 477.4 mm. For example, the district of Qazigund recorded over 550 mm of rainfall in 6 days as against a historic normal of 6.2 mm over the same period.

Due to the unprecedented heavy rainfall the catchment areas particularly the low lying areas were flooded for more than two weeks. Some areas in urban Srinagar stayed flooded for 28 days. Water levels were as high as 27 feet in many parts of Srinagar. The areas from the main tributaries of river Jhelum vis-à-vis Brenginallah, Vishavnallah, Lider nallah and Sandran nallah started overflowing due to the heavy rainfall causing water levels in Jhelum river to rise. Subsequently, the discharge of the river Suran was 200 thousand cusecs as against an average of 50 thousand cusecs. With the excessive discharge of water, the river Suran affected the basin areas and also took a different course at various locations causing damages to the surrounding villages in the catchment area. Water levels also increased in the rivers of Chenab and Tawi, both of which were flowing above normal levels. Due to the rivers overflowing nearly 20 districts of the State were impacted.

A Joint team led by the Department of Economic Affairs (DEA), GoI, with representation from the World Bank visited J&K on October 21, 2014. Subsequently, GoI has sent a request to the World Bank on January 5, 2015 to field a Joint Rapid Damage and Needs Assessment (RDNA) Mission within the State. In response, a mission of the World Bank visited the state during February 1-6, 2015 in order to produce a rapid multi-sectoral assessment report of the damages and needs. The RDNA estimates the total

damages and loss caused by floods at about INR 211,975 million (US\$ 3,550.45), most of it to housing, livelihoods, and roads and bridges, which combined represented more than 70% of the damages in terms of value. Public service infrastructure and equipment of hospitals and education centres were also severely damaged and are still not fully operational.

Based on the RDNA results, restoration works underway, and discussions with the GOJ&K, the project will focus on restoring critical infrastructure using international best practice on resilient infrastructure. Given the state's vulnerability to both floods and earthquakes, the infrastructure will be designed with upgraded resilient features, and will include contingency planning for future disaster events. Therefore, the project aims at both restoring essential services disrupted by the floods and improving the design standard and practices in the state to increase resilience.

The project is comprised of the following seven components:

- i. Reconstruction and strengthening of critical infrastructure (US\$60 million)
- ii. Reconstruction of roads and bridges (US\$80 million)
- iii. Restoration of urban flood management infrastructure (US\$50 million)
- iv. Strengthening and restoration of livelihoods (US\$15 million)
- v. Strengthening disaster risk management capacity (US\$25 million)
- vi. Contingent Emergency Response (US\$0 million)
- vii. Implementation Support (US\$20 million)

1.2 Project Development Objective

The Project Development Objective (PDO) is to support the recovery and increase disaster resilience in targeted areas of the state, and increase the capacity of the State entities to respond promptly and effectively to an eligible crisis or emergency.

1.3 Sub-project Background:

The Component-1 of the project (JTFRP) envisages the construction/reconstruction and strengthening of critical infrastructure severely affected by the floods in September, 2014 viz., education buildings, hospitals, fire stations and other important public assets. It will include the restoration of partially damaged structures and the reconstruction of fully damaged structures, including equipment and furniture. Assessments will be

carried out to determine the extent of structural integrity and retrofitting/reconstruction needs. For colleges/schools, the reconstruction will be focused on replacement of damaged buildings. The component will also finance the repair and reconstruction of damaged hospitals, higher education, fire station, and other public buildings, including the procurement of equipment/furniture, etc.

1.4 Sub-project description

Situated in the heart of Capital City Srinagar, Government College for Women is a premier institution of Higher Learning for women in the State of Jammu and Kashmir. The Government of Jammu and Kashmir established the college in October 1950, during the reign of the then Prime Minister of Jammu and Kashmir Sheikh Mohammad Abdullah. The college has a glorious past with excellent academic track record and has played a pivotal role for women education and empowerment in the state. Presently this college is one of the few colleges in the country and so-far the only Degree College in the State of Jammu and Kashmir with NAAC Accredited Grade A, a testimony to the academic excellence and quality culture achieved and maintained by the College. The College joined the elite club of institution with facilities of satellite based education by setting up of an Edusat Hub for Kashmir valley in the College. The college is located near J&K bank Corporate Head Quarters with Dalgate on its East, Maisuma on its West, Barbarshah to its North and Residency Road on its Southern side. The college lies between coordinates of **34° 03'36" N latitude, 74° 48'31" E longitude** and 1589m altitude. It is spread over 3.39 hectares of land divided into a playground, parks, gardens and infrastructural area.

The proposed subproject "Construction of Lecture hall block at women College Srinagar, will be constructed under World Bank funded Jhelum & Tawi Flood Recovery Project. The design of the Lecture hall block has taken into consideration the seismicity of the region and other factors. Planning principles and design considerations have also been reviewed and incorporated into the site planning process whenever possible. The Lecture hall block will comprise of four floor with one stilt floor, ground floor having four lecture halls (04,two washrooms and a separate washroom for specially abled students, first and second floors will have the same accommodations with added common room and one utility room.

Design :

The building shall rest on RCC Raft / Pile foundation with plinth beams as per design. RCC Frame structure has been proposed with non-load bearing panels of bricks/ hollow blocks (110 mm brick work and 200 mm hollow block) masonry in cement for the building. RCC slab shall be laid over and shall be provided with steel roof truss with colour coated CGI sheets in accordance with structural design. Wooden frames of designed section shall be provided for doors, /Windows and glazed/panelled shutters wood or equivalent shall be provided in accordance with the approved architectural design. The wood work shall be painted / polished with paint of approved quality. The floor shall be of Kota/Terrazzo/ Vitrified Tiles/ Granite as per the norms freezed in CPWD cost index. All other areas including ceiling shall be cement plastered and finished with POP and emulsion paint of approved shade. The ceilings of classrooms shall be of gypsum board false ceiling. The toilets shall be provided with concealed sanitary and plumbing pipes/fittings with the requisite fixtures, china ware etc .in accordance with the approved specifications

S.NO	FLOOR	ACCOMODATION TYPE	NUMBER	SIZE
1	LEVEL 01	Lecture hall	04	9m X 8m
		Toilet Block	02	3.5m x 5.75m
		Specially abled wash room	01	2.14m x 1.80m
2.	Level 02 &04	Lecture hall	04	9m X 8m
		Common room	01	6.3 x 8m
		Toilet Block	02	3.5m x 5.75m
		Specially abled wash room	01	2.14m x 1.80m
		Utility room	01	2.14m x1.80m
3.	Level 03	Lecture hall	04	9m X 8m
		HOD and Staff room	01each	3.03 mx 5.07m 3.03m x 3.04m
		Toilet Block	02	3.5m x 5.75m

		Specially abled wash room	01	2.14m x 1.80m
		Utility room	01	2.14m x1.80m

Existing site plan of women's college

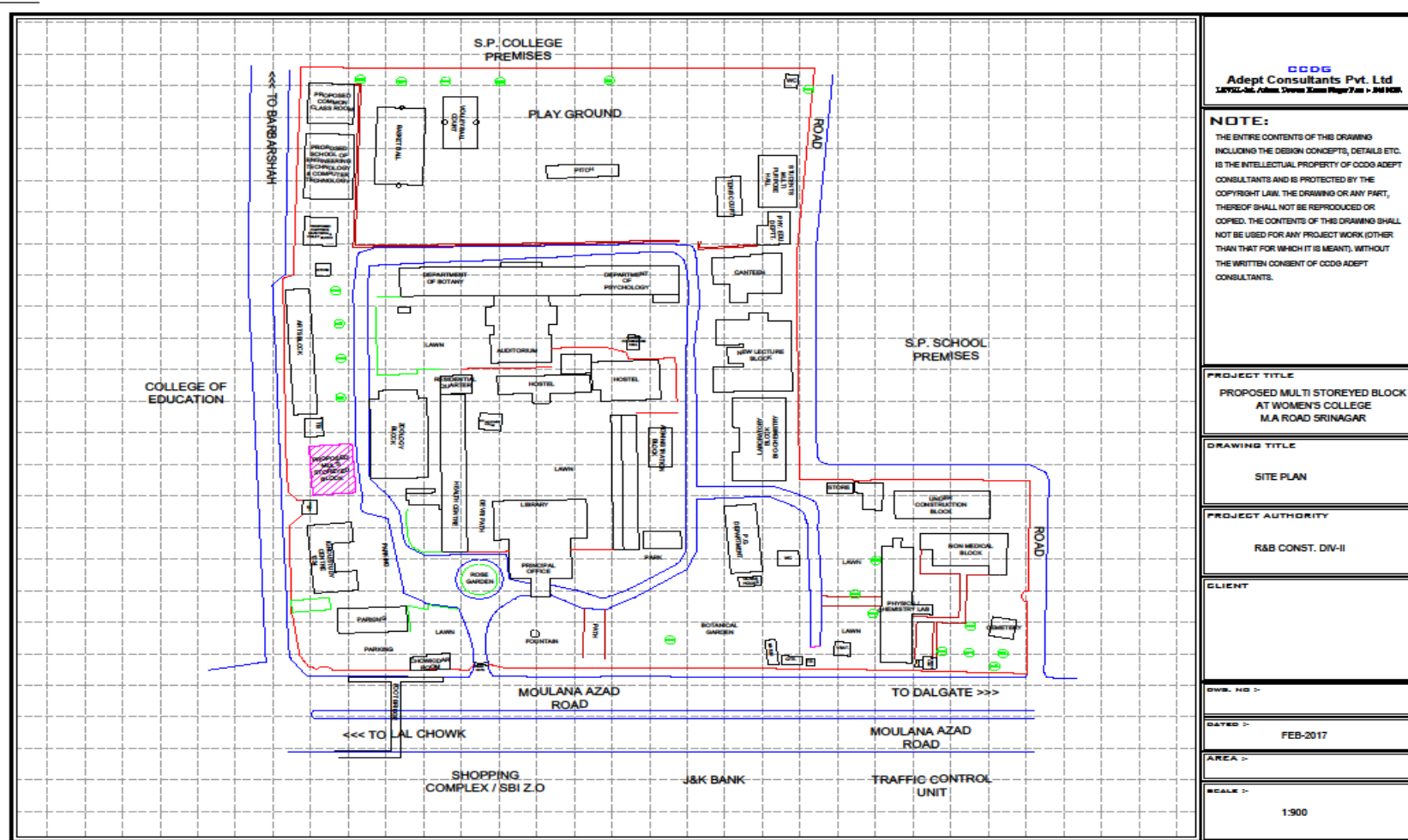

<p>CCDC Adept Consultants Pvt. Ltd 127521-66, Adm. Tower Xmas Plaza 7th Flr - J&K PCB</p> <p>NOTE: THE ENTIRE CONTENTS OF THIS DRAWING INCLUDING THE DESIGN CONCEPTS, DETAILS ETC. IS THE INTELLECTUAL PROPERTY OF CCDC ADEPT CONSULTANTS AND IS PROTECTED BY THE COPYRIGHT LAW. THE DRAWING OR ANY PART, THEREOF SHALL NOT BE REPRODUCED OR COPIED. THE CONTENTS OF THIS DRAWING SHALL NOT BE USED FOR ANY PROJECT WORK OTHER THAN THAT FOR WHICH IT IS MEANT, WITHOUT THE WRITTEN CONSENT OF CCDC ADEPT CONSULTANTS.</p>
<p>PROJECT TITLE PROPOSED MULTI STOREY BLOCK AT WOMEN'S COLLEGE M.A ROAD SRINAGAR</p>
<p>DRAWING TITLE SITE PLAN</p>
<p>PROJECT AUTHORITY R&B CONST. DIV-II</p>
<p>CLIENT</p>
<p>DWR. NO ></p>
<p>DATED > FEB-2017</p>
<p>AREA ></p>
<p>SCALE > 1:900</p>

Master Plan Showing Scope of Future Expansion

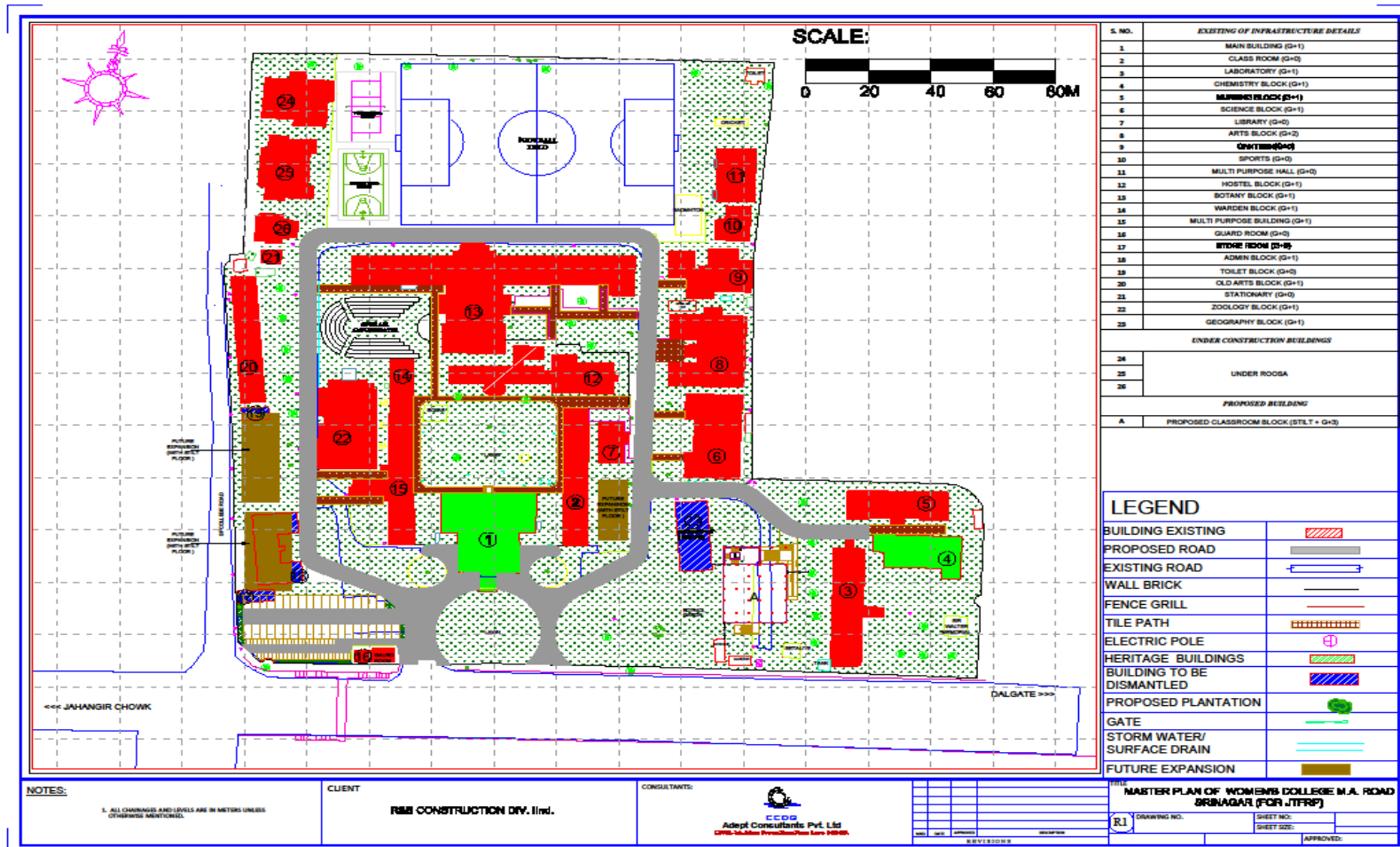

Environmental Screening of Women's College M.A Road Srinagar

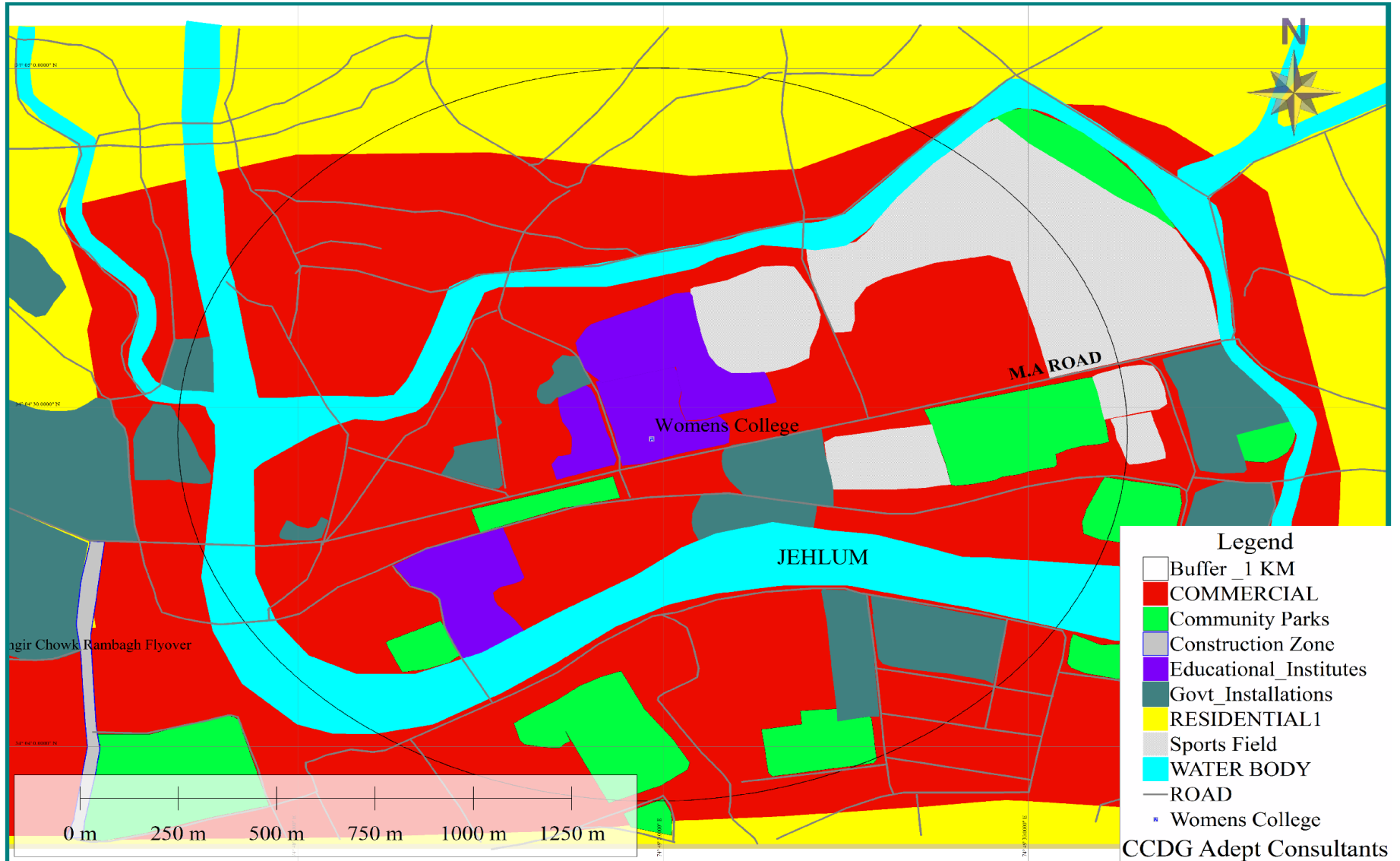

1.5 Objective of the Environmental and Social Screening

Subprojects under “Jhelum and Tawi Flood Recovery Project” commonly known as JTFRP have a prior requirement of screening which is based on three categories; viz., nature of the project, size of the project and location of the project that is sensitive area criteria. Based on this assessment, sub-projects with potentially significant environmental/ social issues are identified at an early stage for detailed Environmental/ Social impacts.

1.6 Methodology of Environment and Social Screening Study

The environment and social screening for the subproject has been carried out at the site by making use of a Environment and Social Screening Checklist (**Appendix–A**) that contains the relevant questions for identification of anticipated environment and social impacts due to execution of the subproject.

2.0. Environment and Social Issues

2.1 Environment Issues

The project will anticipate any adverse, significant, or irreversible negative environmental impacts neither during the construction, nor at operation phase. Impacts of the construction phase will be typical for all medium scale construction activities, short-term/ temporary and limited to the project site. No Impacts small, medium or large scale shall be encountered during the operation phase as the same comprises of academic activity only.

There are no sensitive areas like specially protected areas, national parks, zoological parks in the sub-project area. Furthermore no threatened, endangered, or endemic species as defined in the ESDS is found in the said area.

2.2 Social Issues:

2.2.1 Availability of land

The proposed sub-project does not involve any land acquisition. The proposed construction will be executed on available land under the ownership of college. The

land ownership documents along with translated copy duly attested are annexed as **Appendix-B & C**. The construction activities shall be executed on the available land under **Khasra no.115** under land type **Banjri Qadeem**¹

2.2.2 Issues of Livelihood

No impact either temporary or permanent envisaged upon the livelihood of anybody.

Therefore, based on the findings during survey, there are no adverse significant environmental as well as social impacts in sub-project area, hence no further special study or detailed environmental impact assessment (EIA)/ Social impact assessment (SIA) needs to be undertaken.

However, Environmental and social Management Plan (ESMP) will provide specific actions deemed necessary to assist in mitigating the environmental impacts, addressing grievances of people (Students, Teachers & other staff) arising out of the subproject related activities and labour management beside other requirements. ESMP will guide the environmentally-sound execution of the subproject, and ensure efficient lines of communication between the implementing agency, project management unit, and contractors. The ESMPs will form part of the bid document and to be reviewed during implementation. The ESMP will be included in the contractual clauses and will be made binding on the contracting firm.

2. Public Consultation

In compliance with the ESMF, public consultations were undertaken during the site visits in the sub- project areas on **24-03-2019 and 03-04-2019**. Different stakeholders like local businessmen, hawkers, teachers, and people from administration, and students (particularly female studying or working within the college) were informed about the proposed sub-project and their views were obtained (**Appendix-D**)

3.1 Consultation Questions discussed

- Need of the subproject.

¹ Banjar means uncultivated land and Banjari Qadeem means old Fallow (If continued to be uncultivated for next four harvests (Source: jkfcr.nic.in/terminology.html)

- Current facilities.
- Project and its source of assistance i.e. World Bank. Its implementation/execution etc.
- Proposed proposal for sub project
- Inconveniences during construction phase with academic activities.
- Study of Environment and Social Screening requirements and benefits and Concept of ESMP.
- Adverse environment impacts and mitigation measures during construction phase.
- Environmental and Social Policy of World Bank.
- Protection and conservation aspects of environmental attributes
- Proposed Grievance Redressal Mechanism for the subproject.

3.2 Outcome and suggestions received from the Public Consultation

The following suggestions were received:

- Proper barricading of construction site during construction phase so that any untoward incident can be avoided in the college campus.
- That mitigation measures should be effective during construction phase.
- That those activities which cause major disturbances should be executed before and after college timing so that academic activity should not be affected.

PW (R&B) department as PIU/ implementing agency ensured that the requisite environmental mitigation measures and social management measures shall be incorporated in ESMP and public consultation shall be a regular process during all stages of the sub -project to solve any issues arising out of the proposed works.

Appendix-A

Environment and Social Screening

Part A: General Information

1. Name of the sub-project	Construction of Lecture hall block at Government College for Women, Srinagar, Jammu and Kashmir	
2. Type of proposed activity (tick the applicable option and provide details)		
▪ Road	<input type="checkbox"/>	-
▪ Bridge	<input type="checkbox"/>	-
▪ Fire Station	<input type="checkbox"/>	-
▪ Hospital/Health Facility	<input type="checkbox"/>	-
▪ Educational Institute	<input checked="" type="checkbox"/>	Govt. College for Women M.A. Road Srinagar
▪ Building for Livelihoods	<input type="checkbox"/>	-
▪ Flood Infrastructure Related	<input type="checkbox"/>	-
▪ Other Public Building	<input type="checkbox"/>	-.
▪ Any Other (Please Specify)	<input type="checkbox"/>	-
3. Location of the proposed sub-project		
▪ Name of the Region	Kashmir (J&K State)	
▪ Name of the District	Srinagar	
▪ Name of the Block	Samandarbagh, M.A.Road	
▪ Name of the Settlement	Samandarbagh	
▪ Latitude	34 ⁰ 03' 36" N	
▪ Longitude	74 ⁰ 48' 31" E	
4a. Proposed Nature of Work (tick the applicable options)		

▪ Minor Repairs	-
▪ Major Repairs/Rehabilitation	-
▪ Upgrading/Major Improvement	-
▪ Expansion of the facility	-
▪ New Construction	✓
▪ Any Other	-
4b. Size of the sub-project (approx. area in sq. mt/hac or	800 Sq.m
5. Land Requirement (in hac./sq.mt.)	
▪ Total Requirement	-
▪ Private Land	-
▪ Govt. Land	-(Existing College Premises)
▪ Forest Land	-
6. Implementing Agency Details (sub-project level)	
▪ Name of the Department/Agency	PW (R&B) Kashmir
▪ Name of the contact person	Er. Javeid Ahmad Bukhari
▪ Designation	Executive Engineer
▪ Contact Number	+91-9419006437
▪ E-mail Id	javeidbukhari@yahoo.com
7. Screening Exercise Details	
▪ Date on which it was carried out	24-03-2019 and 03-04-2019
▪ Name of the Person	Mr. Kaiser Rafiq
▪ Contact Number	8713927709 / 7006382221
▪ E-mail Id	rafiq.kaiser@yahoo.com

Part B (1): Environment Screening

Question	Yes	No	Details
1. Is the sub-project located in whole or part within 1 km of the following environmentally sensitive areas?			
a. Biosphere Reserve		No	
b. National Park		No	
c. Wildlife/Bird Sanctuary		No	
d. Wildlife/Bird Reserve		No	
e. Important Bird Areas (IBAs)		No	
f. Habitat of migratory birds (outside protected areas)		No	.
g. Breeding/Foraging/Migratory route of Wild Animals (outside protected areas)		No	
h. Area with threatened/rare/endangered fauna (outside protected areas)		No	
i. Area with threatened/rare/endangered flora (outside protected areas)		No	
j. Reserved/Protected Forest		No	
k. Other category of Forest		No	
l. Wetland		No	.
m. Natural Lakes		No	

n. Rivers/Streams	Yes		<p>1. Fakhray Kashmir Stream is 100-200 meters towards North of the proposed site</p> <p>2. Jhelum river is 300 meters towards South of the proposed sub-project site.</p>
o. Swamps/Mudflats		No	
p. Zoological Park		No	
q. Botanical Garden		No	
4. Is the sub-project located in whole or part within 500 mts. of any of the following sensitive features?			
a. World Heritage Sites		No	
b. Archaeological monuments/sites (under ASI's central/state list)		No	
c. Historic Places/Monuments/Buildings/Other Assets (not listed under ASI list but considered locally important or carry a sentimental value)	Yes		Old heritage block/building comprising Principals office, staff room, smart class room, examination cell and library.
d. Religious Places (regionally or locally important)		No	
e. Reservoirs/Dams		No	
f. Canals		No	
g. Public Water Supply Areas from Rivers/Surface Water Bodies/Ground Water Sources		No	
4. What is the High Flood Level in the sub-project area?	12 feet in college campus		
5. Is any scheduled/protected tree like Chinar, Mulberry or Deodar likely to be affected/cut due to the project?		No	

6. Is the sub-project located in a landslide/heavy erosion prone area or affected by such a problem?		No	
7. Is sub-project located in an area that faces water paucity or water quality issues?		No	

Part B (2) : Result/Outcome of Environmental Screening Exercise		
1.	Environment Impact Assessment Required	No
2.	Environment Clearance Required	No
3.	Forest land Clearance/Diversion Required	No
4.	Tree Cutting Permission Required	No
5.	ASI (Centre/State) Permission Required	No
6.	Permission from ULB/Local Body/Department Required	Yes
		Permission for Building Construction will be required from Srinagar Municipal Corporation (SMC).
7.	Any other clearance/permission required	Yes
		Various Statutory clearances and NOC's / PUC's for establishment or operation of stone crushers, generators, vehicles etc shall be required to be obtained by the Contractor from the concerned authorities. Construction material will be procured only from permitted sites and licensed /authorized quarries/ borrow sites.

Part C (1): Social Screening

1. Does the sub-project activity require acquisition of land?			
Yes		No	√
Give the following details:	Private Land (sqmts/hac.)		No
	Govt. Land (sqmts/hac.)		No
	Forest Land (sqmts/hac.)		No
2. Does the proposed sub-project activity result in demolition/removal of existing structures?			
Yes		No	√
If so, give the following details:			
▪ Number of public structures/buildings		No	
▪ Number of common property resources (such as religious/cultural/ drinking water/wells/etc.)		-	
▪ Number of private structures (located on private or public land)		-	
3. Does the proposed project activity result in loss of crops/trees?			
Yes		No	√
4. Does the proposed Project activity result in loss of direct livelihood/ employment?			
Yes		No	√
5. Does the proposed activity result in loss of community forest/pastures on which nearby residents/local population are dependent?			

Yes		No	√
If yes, give the details of the extent of area to be lost (in acres/hac).			
6. Does the proposed Project activity affect scheduled tribe/caste communities?			
Yes		No	√

Part C (2): Result/Outcome of Social Screening Exercise

S.No.	Result/Outcome	Outcome
1.	Answer to all the questions is 'No' and only forest land is being acquired	NA
2.	Answer to any question is 'Yes' and the sub-project does not affect more than 200 people (i.e. either complete or partial loss of assets and/or livelihood)	No
3.	Answer to any question is 'Yes' and the sub-project affects more than 200 people (i.e. either complete or partial loss of assets and/or livelihood)	No

Outcome

The proposed sub-project will not have any significant environmental & social impacts. There may be some short term inconvenience to staff, students and local citizens due to construction but it will be for very short period. To address the same, ESMP will be implemented during construction to mitigate any kind of inconvenience.

No EIA and SIA is required for the subproject site. However, the subproject would require preparation of ESMP.

Statutory Clearances/ No Objection Certificate:

Only Statutory clearances and NOC's / PUC's for establishment/operation of stone crushers, generators, vehicles etc. shall be required to be obtained by the Contractor

انتخاب خسره گرداوری موضع مالیه تحصیل سوئے ضلع سرعانگ

رقبہ	رقبہ		نام مالک معہ احوال	نام کاشتکار معہ احوال	نمبر
	کلی	جزی			
۱۱۵	۳۶	۱۹	مقبوضہ گرز کالج	کارہ	۱۱۵
	۲	۱۲			
	۱	۲			
	۱	۱			
	۱۸	۱۸			
	۲۶	۱۵			
۲۲۰	۳۳	۳۳	سریناب کالج	کارہ	۲۲۰
۱۱۶	۳	۳	مقبوضہ گرز کالج	کارہ	۱۱۶
	۳۵	۳۵			

نوٹ: نثرینہ احمد اکرم اینڈ سونڈریز سٹور انڈیا - جسٹس کفر انڈیا ہے

۵/۱/۱۹
 Gulzar Ali
 Pat. Halwa
 Teh.
 S.
 Ruler

انتخاب جمعیتی ملکیت ابات موضع مالسم تحصیل سوئم ضلع سرمانہ مرتبہ سال ۱۹۹۳-۹۲

۱	۲	۳	۴	۵	۶	۷	۸	۹	۱۰	۱۱	۱۲	۱۳
نمبر ملکیت	نمبر ملکیت	نام مالک معہ احوال	نام مالک کا شکار معہ احوال	وساکن آبیائی	نام سرزمین معہ احوال	رقبہ تقریبی	لگان جو زرہ اور آرائے	پریشوار	مطالبہ تخریب سال رسوا	حوالہ نقلات	نمبر	نمبر
۷۷	۱۴۶	سکر	عابد بناب کالچ قبوضہ گرلز کالج		۱۱۶	۳	نمبر ۱۱۵		۱			
	۱۵۰		قبوضہ گرلز کالج		۱۱۵	۱۶	نمبر ۱۱۶					

نوشہ نمبر ۱۱۵ و ۱۱۶ کے متعلقہ زمینوں کے قبضہ داروں کی فہرست

۱۱/۱۱/۱۹
Guzar Ali Rafter
Pat. Halla
Ten.

Appendix-C

Translated copy of land ownership copy

**ENGLISH TRANSLATION COPY OF
INTIKHAB KHASRA GIRDAWARI
VILLAGE/ESTATE MAISUMA, TEHSIL SOUTH,
DISTRICT SRINAGAR**



(1) Khasra No.	(2) Name of Owner with Details	(3) Name of Cultivator with Details	(4) Area		(6) Type of Land	(7) Levy, etc.	(8) Remarks
			Kanal	Marla			
115	State	Under occupation of Girls College.	39	19	Banjri Qadeem Miskan Office	—	—
			4	14			
			—	4			
			1	—			
			—	18			
47	15						
240/116	State	Sri Pratap College. Occupation of Girls College.	23 2 25	— — —	Banjri Qadeem	—	—

NOTE:

The duplicate has been issued as per the orders.

Sd/- Patwari
Halqa Maisuma



Translation Attested
on Date 2024-1-17

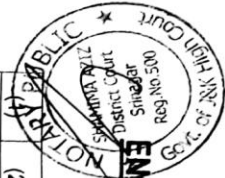

**ENGLISH TRANSLATION COPY OF INTIKHABI JAMABANDI (REVENUE EXTRACTS) VILLAGE/ESTATE
MAISUMA, TEHSIL SOUTH, DISTRICT SRINAGAR**

Khwat No.	Khatta No.	Name of Surr.	Name of Owner with Details	Name of Cultivator with Details	Means of Irrigation	Khasra Nos.	Total area	Mutable Lagan (Tax/Levy)	Type	Rate of Malia	Mudsons		Details
											No.	Type	
77	166	---	State	Sri Pratap College under occupation Girls School Under Occupation of Girls College		240/116 115 10 3 2 4K 14M 4M 1K 32K 15M	10 3 2 5K 16M "	-	Banjri Qadeem	-	-	-	-
									Banjri Jadeed Banjri Qadeem Houses				

NOTE:
The duplicate has been issued as per the orders of Tehsildar along with Intikhab Girdawari and Sajra for khasra No. 15 146-mln

Sd/- Patwari Halqa Maisuma



Transacted & Assisted
on Date 15-1-19

Appendix-D

Public consultation with different stakeholders

Public Consultation for JIFRP
Jammu & Kashmir

Subproject name: Construction of leakage Hall Block at Govt. ~~College~~ Women's College, M.A
 Location: Legal Quatre District: Srinagar. Road, Srinagar.
 Date: 24-05-2019 Time: 4:30 PM.

Information of Participants

Sl. No.	Name	Gender	Category (SC/ST/OBC/Gen/BPL)	Address	Occupation / Unit	Mobile number
1	Saved Ahmad	male	GEN	Bemina	Javed Tea Stall Samarudha Singh	9596353315
2	Hilal Ahmad	Do	Do	Srinagar	Mamta Bock Deva	6194-2454700
3	Sarvea	Do	Do	Srinagar	Butterfly Entrepreneur	9419016656
4	Shahbaz Ahmad	Do	Do	Samarudha Singh	Haji. Mohi-ud Rangam & Sons	9419008997
5	Abdul Hameed	Do	Do	Sadgaon	Royal Electronics	9796760330
6	Ajib Ahmad	Do	Do	Raj Bagh	SK Stationery	0194-2483570
7	Mohajir-ud-din	Do	Do	Lal Quatre	Deen Printers	9419595262
8	Hilal Ahmad	Do	Do	Hydpora	Hameed Motor's	0194-2474735
9						

Public Consultation for JFRP

Jammu & Kashmir

Subproject name: Construction of Lecture Hall Block at Govt. Women's College, M.A Road

Location: Repal Buzark District: Srinagar Srinagar

Date: 24-03-2019 Time: 5:30 PM

Information of Participants

Sl. No.	Name	Gender	Category (SC/ST/OBC/Gen/BPL)	Address	Occupation	Mobile number
1	Nisar Ahmad	Male		Zakusa	Ecstasy stationary Zoon of legal	9622423765
2	Aliq Ahmad	DO		Bemina		9149572727
3	Tarig Ahmad Nami			Bemina	Canon	9419005432
4	Rafiq Ahmad	DO		Champora		9050450405
5	Muqeet Ahmad	DO		Samadabagh	Multi trading agency	9796112929
6						
7						
8						
9						

Interaction with students

Public Consultation for JFRP

Jammu & Kashmir

Subproject name: Construction of Lecture hall block at Govt. women's college,
 Location: Srinagar District: Srinagar M.A Road Srinagar.
 Date: 03/04/19 Time: 10:30 am

Scanned by CamScanner

Information of Participants

Sl. No.	Name	Gender	Category (SC/ST/OBC/Gen/BPL)	Address college	Occupation Stream / Specialty	Mobile number
1	Azra	Female	Gen	W.C.M.A. Road	Science	98191
2	Zehra Fatima	"	ST	"	Arts	98191
3	Bakra	"	Gen	"	Science	98191
4	Zalida	"	Gen	"	Science	98191
5	Saba Jan	"	Gen	"	Arts	98191
6	Sadaf	"	Gen	"	Arts	98191
7	Naila	"	Gen	"	Science	98191
8	Shabina	"	BPL	"	Science	98191
9	Ahmad	"	Gen	"	Arts	98191

Public Consultation for JTFRP

Subproject name: Construction of Lecture Hall block at Govt. women's college,
Jammu & Kashmir
 Location: Smajra District: Smajra M.A Road Smajra

Date: 03/04/19 Time: 10:30 am

Scanned by CamScanner

Information of Participants

Sl. No.	Name	Gender	Category (SC/ST/OBC/Gen/BPL)	Address	Occupation	Mobile number
1	Talima	Female	SC	college women college M.A Road Smj	Stream/Sem Arts	Talima
2	Ayda	"	Gen	"	"	Ayda
3	TABASUM	"	Gen	"	"	Tabasum
4	Arifa	"	"	"	"	Arifa
5	Saima	"	"	"	Science	Saima
6	Talima	"	"	"	science	Talima
7	Razia	"	ST	"	Arts	Razia
8	Naima	"	ST	"	Arts	Naima
9	Khatiba	"	SC	"	Science	Khatiba

Interaction with staff

Public Consultation for JIFRP

Jammu & Kashmir
Leisure Hall block of Govt. Women's college

Subproject name: Construction of
 Location: College campus District: Srinagar.
M.A college, Srinagar.

Date: 03/04/2018 Time: _____

Information of Participants

Sl. No.	Name	Gender	Category (SC/ST/OBC/Gen/BPL)	Address	Occupation	Mobile number
1	Dr. Athar	Male	GEN	Sangam, Satta.	Asst. Professor	7006609456
2	Plumod Nigat					
3	Mt. Umar, Ahmad Farid, Kaseem, Shabir			Peer bogli, Hyderabad, Nowshera.		7006692301
4	Tafar, Majeed			M.A. Road.	Asst. Professor	
5	Farooq Bta					
6	Tadavunah, Akhtra					
7	Sumeera, Anahis					
8	Syed Anwar					
9	Farooq Bta.					
10	Shafiq, Taleem, Anwar				Section Officer, Sn. Assistant	

Scanned by CamScanner

Appendix-E

Photographs of Existing infrastructure

Plate.1.Red line showing flood level (2014)



Plate.2. Arts block



Plate.3. Heritage building



Plate.4.flood affected old geography block



Plate.5 under construction block



Plate.6. Administrative building



Plate.7. flood affected class rooms



Plate.8. interaction with staff



Plate.9. Interaction with owner of adjacent business units



Plate.10. interaction with shopkeepers.



Plate.11. Interaction with shopkeepers.



Plate.12. interaction with Hawkers near college campus

