

Environment and Social Screening Report

September: 2020

Project ID: P154990

Subproject: Construction of 4 roomed classroom blocks with separate toilet block for Boys and Girls at Govt. High School, Dogripora, Pulwama, J&K.

(Jhelum & Tawi Flood Recovery Project)

Prepared by PW (R&B) Department Kashmir: Government of Jammu & Kashmir,
for the World Bank

CONTENTS

EXECUTIVE SUMMARY	3
1. INTRODUCTION	5
1.1 PROJECT BACKGROUND	5
1.2 PROJECT DEVELOPMENT OBJECTIVE	5
1.3 SUBPROJECT BACKGROUND	6
1.4 SUB-PROJECT DESCRIPTION	6
1.5 OBJECTIVE OF THE ENVIRONMENTAL AND SOCIAL SCREENING	10
1.6 METHODOLOGY OF ENVIRONMENT AND SOCIAL SCREENING STUDY	10
2. ENVIRONMENT AND SOCIAL ISSUES	11
2.1 ENVIRONMENT ISSUES	11
2.2 SOCIAL IMPACTS:	11
2.2.1 AVAILABILITY OF LAND	11
2.2.2 ISSUE OF LIVELIHOOD	11
3. PUBLIC CONSULTATION	12
3.1 ISSUES DISCUSSED	12
3.2 OUTCOME AND SUGGESTIONS	12
4. ENVIRONMENTAL & SOCIAL MANAGEMENT PLAN	12
STATUTORY CLEARANCES/ NO OBJECTION CERTIFICATE.....	20

LIST OF FIGURES

<i>FIGURE 0-1: CONSULTATION PHOTOS</i>	<i>26</i>
--	-----------

EXECUTIVE SUMMARY

The devastating floods of September 2014 show negative impact on socio-economic aspects of the Union Territory of J&K (erstwhile state) and massive infrastructure damaged in Kashmir division. In response, a mission of the World Bank visited the J&K during February 1-6, 2015 in order to produce a rapid multi-sectoral assessment report of the damages and needs. The RDNA estimates the total damages and loss caused by floods at about INR 211,975 million (US\$ 3,550.45), most of it to housing, livelihoods, and roads and bridges, which combined represented more than 70% of the damages in terms of value. Public service infrastructure and equipment of hospitals and education centers were also severely damaged and are still not fully operational.

Based on the RDNA results and discussions with the GOJ&K, the “Jhelum and Tawi Flood Disaster Recovery Project (JTFRP)” will focus on restoring critical infrastructure using international best practice on resilient infrastructure. One of the sectors badly hit during the floods was education (school/college), the restorations of which have been included in the Component-1 of the World Bank investment.

Govt. High School, Dogripora, Pulwama (Kashmir) was affected by the floods due to the low lying area and its proximity to river Jehlum. The whole school Govt. High School, Dogripora, Pulwama was inundated up to 05 feet from the plinth height. The school stayed flooded for more than 10 days. The existing infrastructure of the school was severely damaged that included two old classroom block and one toilet block. The total roll of the students in the school is **188**. Presently, the classroom block is not sufficed for the existing roll. The infrastructure shortcomings as put forth by students and staff are definitely a Gap for imparting quality education and can be met only after the execution of sub-project. After post floods school starts its rebuilding process and a proposal for the said sub-project “Construction of 04 roomed single story building with separate toilet block for boys and girls at Govt. High School, Dogripora” was finalized and included in Jhelum and Tawi Flood Recovery Project (JTFRP).

Subprojects under “Jhelum and Tawi Flood Recovery Project” have a prior requirement of screening which is based on three categories; viz., nature of the project, size of the project and location of the project that is sensitive area criteria. The objective of Environment and social screening is to identify the potentially significant environmental/ social issues of the sub-project at an early stage for detailed Environmental and Social impacts.

The screening study revealed that the proposed sub-project does not involve land acquisition. As per the revenue record the sub-project is proposed on the government land on khasra number 1859 which is under the ownership of school (Appendix II). Footnotes given on the translated revenue documents shows that on Khasra number 1859-min Government High School Dogripora exists which is encumbrance free and there is no dispute in the village pertaining to the school. The school premise is provided with boundary walls from all sides & is free from any encroachment. There is no agricultural activity inside the school premises.

Public consultations were undertaken during the site visits in the sub- project areas on 08-09-2018 and thereafter on 27-06-2020. Teachers, students and people from village were informed about the proposed sub-project and their views were obtained.

The screening study reveals that there are no likely social or environmental impacts of the proposed sub-project. There is no requirement of land acquisition, no involuntary resettlement and physical or economic displacement.

1. INTRODUCTION

1.1 Project Background

In September 2014, J&K experienced torrential monsoon rains in the region causing major flooding and landslides. The continuous spell of rains from September 2-6, 2014, caused Jhelum and Chenab Rivers as well as many other streams/tributaries to flow above the danger mark. The Jhelum River also breached its banks flooding many low-lying areas in Kashmir, including the capital. In many districts, the rainfall exceeded the normal by over 600%. Due to the unprecedented heavy rainfall the catchment areas particularly the low lying areas were flooded for more than two weeks. Some areas in Kashmir and in urban Srinagar and Anantnag stayed flooded for 28 days. Water levels were as high as 27 feet in many parts of Srinagar.

Based on the **Rapid Damage Needs Assessment (RDNA)** results, restoration works underway, and discussions with the GoJ&K, the project will focus on restoring critical infrastructure using international best practice on resilient infrastructure. Given the erstwhile state's vulnerability to both floods and earthquakes, the infrastructure will be designed with upgraded resilient features, and will include contingency planning for future disaster events. Therefore, the project aims at both restoring essential services disrupted by the floods and improving the design standard and practices in the erstwhile state to increase resilience.

1.2 Project Development Objective

The Project Development Objective (PDO) is to support the recovery and increase disaster resilience in targeted areas of the Union Territory of J&K (erstwhile state), and increase the capacity of the erstwhile state entities to respond promptly and effectively to an eligible crisis or emergency.

The project is comprised of the following seven components:

- I. Reconstruction and strengthening of critical infrastructure (US\$60 million)
- II. Reconstruction of roads and bridges (US\$80 million)
- III. Restoration of urban flood management infrastructure (US\$50 million)
- IV. Strengthening and restoration of livelihoods (US\$15 million)
- V. Strengthening disaster risk management capacity (US\$25 million)
- VI. Contingent Emergency Response (US\$0 million)
- VII. Implementation Support (US\$20 million)

1.3 Subproject Background

The objective of this component of the “Jhelum and Tawi Flood Recovery Project” is to support the reconstruction/restoration of damaged public buildings, such as schools, higher education buildings, hospitals, fire stations, and selected block and district offices, and other important public buildings. It will include the restoration of partially damaged structures and the reconstruction of fully damaged structures, including equipment and furniture. The component will finance infrastructure and equipment damaged by the disaster, and improvements to current structures to increase resilience. Assessments will be carried out to determine the extent of structural integrity and retrofitting/reconstruction needs. For colleges/schools, the reconstruction will be focused on replacement of damaged buildings. The component will also finance the repair and reconstruction of damaged hospitals, higher education, fire station, and other public buildings, including the procurement of equipment/furniture, etc.

1.4 Sub-project description

The proposed sub project “Construction 04 roomed single story building with separate toilet block for boys and girls at Govt. High school, Dogripora” is funded by World Bank. The Project Implementation Unit (PIU) for this sub-project will be Public Works (R&B) Department, (Kashmir) Govt. of Jammu & Kashmir.

The classroom block will accommodate 04 classrooms. Besides separate washrooms blocks will be constructed for student’s convenience with multiple cubicles. The execution of this sub-project will result in effective academic activities. The design of these blocks has taken into consideration the seismicity of the region and other factors. Planning principles and design considerations have also been reviewed and incorporated into the site planning process whenever possible. The building shall rest on RCC Raft / Pile foundation with plinth beams as

per design. RCC Frame structure has been proposed with non load bearing panels of bricks/ hollow block(110 mm brick work and 200 mm hollow block) masonry in cement for the building. RCC slab shall be laid over and shall be provided with steel roof truss with colour coated CGI sheets in accordance with structural design. Wooden frames of designed section shall be provided for doors, /Windows and glazed/panelled shutters wood or equivalent shall be provided in accordance with the approved architectural design. The wood work shall be painted / polished with paint of approved quality. The floor shall be of Kota/Terrazzo/ Vitrified Tiles/ Granite as per the norms freezed in CPWD cost index. All other areas including ceiling shall be cement plastered and finished with POP and emulsion paint of approved shade. The toilets shall be provided with concealed sanitary and plumbing pipes/fittings with the requisite fixtures, chinaware etc. in accordance with the approved specifications.

Lay out plan

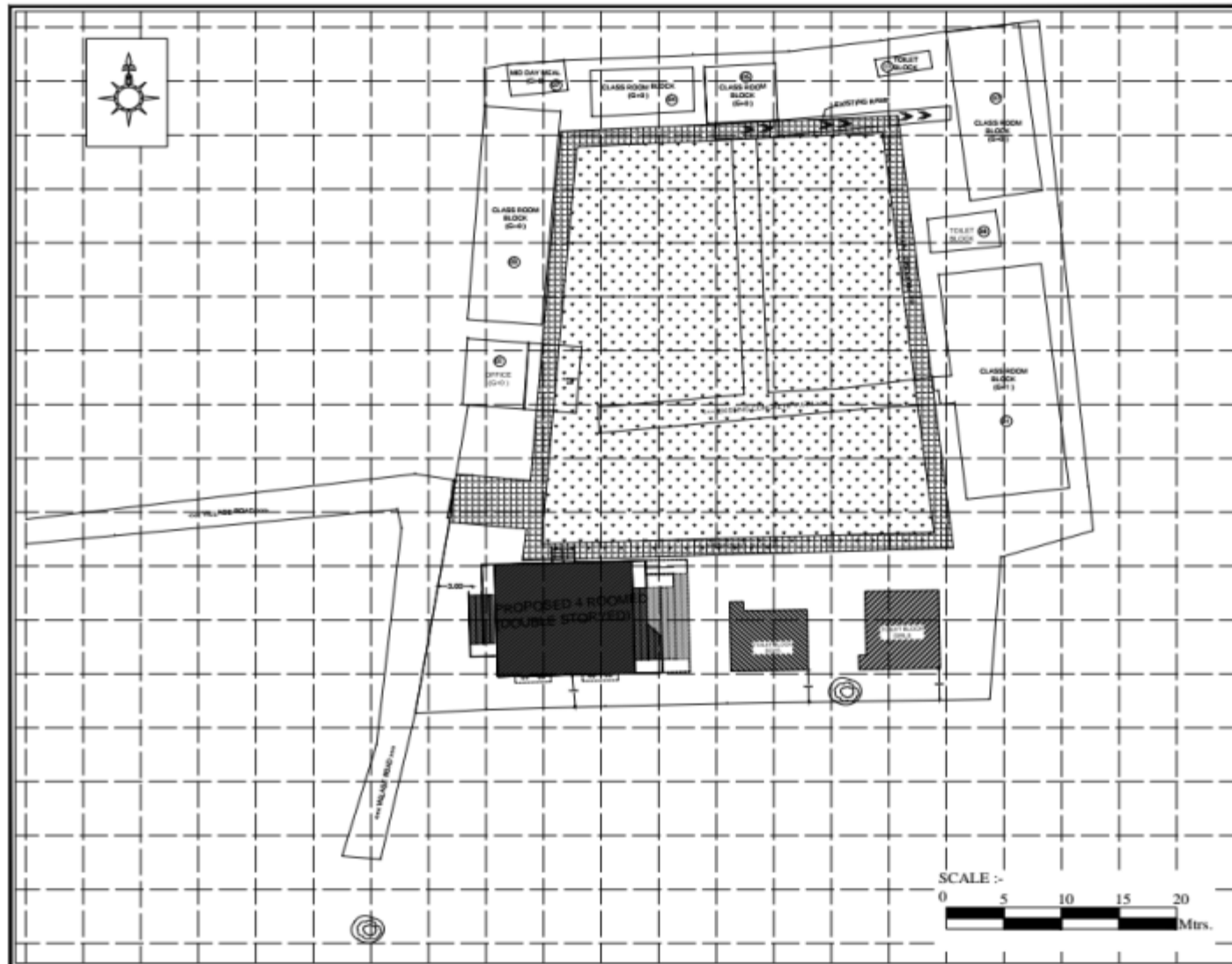

CCDS
Adept Consultants Pvt. Ltd
 LEVEL 4th, Ashok Tower, Karam Nagar, Post - 2011425

NOTE:

THE ENTIRE CONTENTS OF THIS DRAWING INCLUDING THE DESIGN CONCEPTS, DETAILS ETC. IS THE INTELLECTUAL PROPERTY OF CCDS ADEPT CONSULTANTS AND IS PROTECTED BY THE COPYRIGHT LAW. THE DRAWING OR ANY PART, THEREOF SHALL NOT BE REPRODUCED OR COPIED. THE CONTENTS OF THIS DRAWING SHALL NOT BE USED FOR ANY PROJECT WORK (OTHER THAN THAT FOR WHICH IT IS MEANT), WITHOUT THE WRITTEN CONSENT OF CCDS ADEPT CONSULTANTS.

PROJECT TITLE

PROPOSED 4-ROOMED DOUBLE STORIED BUILDING AT H.S. DOGRIPORA PULWAMA (UNDER J.T.F.R.P)

DRAWING TITLE

SITE PLAN

PROJECT AUTHORITY

R&B DIV. PULWAMA

CLIENT

DESIGNED AND DRAFTED BY :-

DATED :-

SCALE :-

Environmental Screening Of HS Dogripora

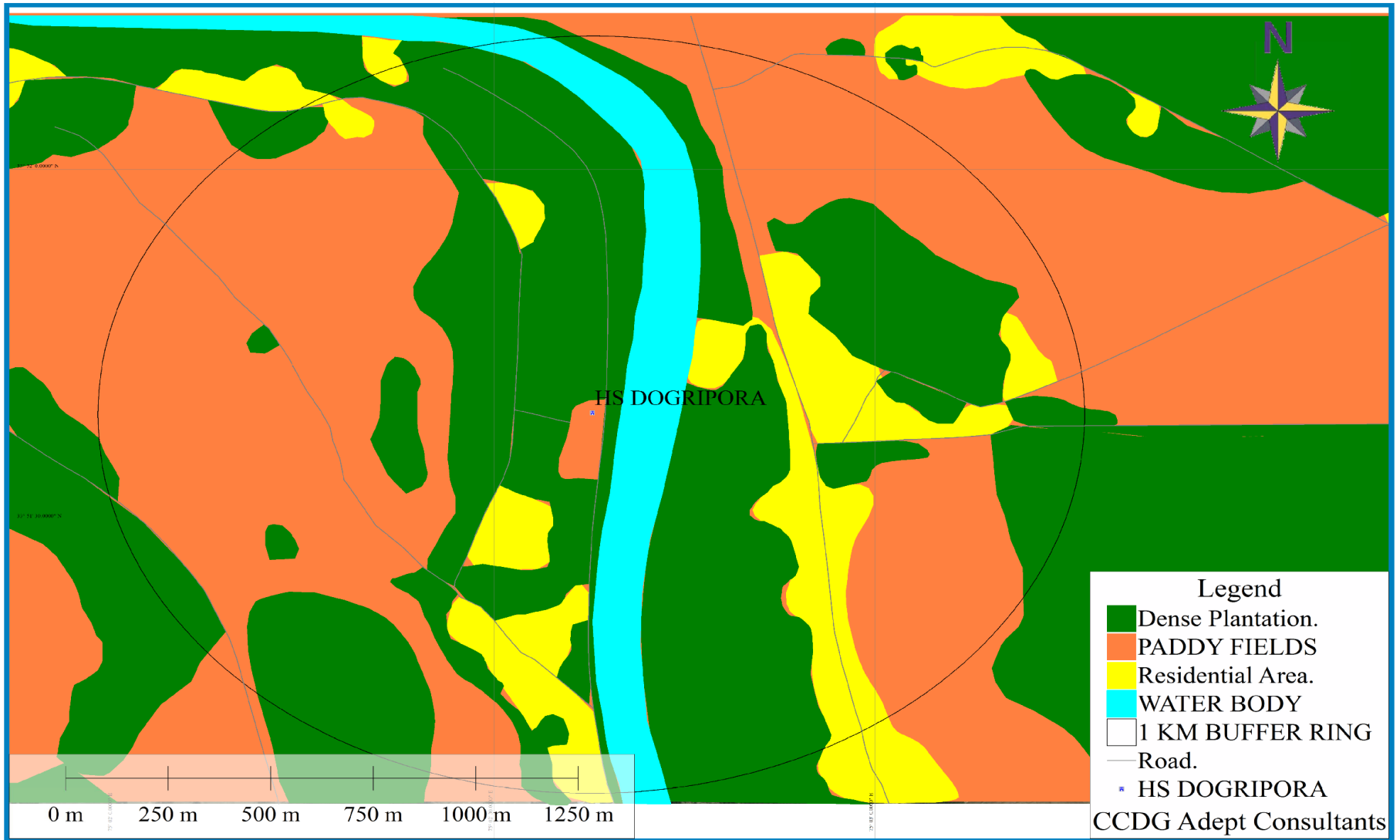

1.5 Objective of the Environmental and Social Screening

Subprojects under “Jhelum and Tawi Flood Recovery Project” commonly known as JTFRP have a prior requirement of screening which is based on three categories; viz., nature of the project, size of the project and location of the project that is sensitive area criteria. Based on this assessment, sub-projects with potentially significant environmental/ social issues are identified at an early stage for detailed Environmental/ Social impacts. Evaluate all the available information on environmental and social aspects as provided in the ESDS and assess, based on the level of expected environmental and social impacts including any field visits, whether the proposed subproject is classified in different categories as per World Bank guidelines.

1.6 Methodology of Environment and Social Screening Study

The environment and social screening for the subproject has been carried out at the site by making use of a Environment and Social Screening Checklist (**Appendix-I**) that contains the relevant questions for identification of anticipated environment and social impacts due to execution of the subproject.

2. ENVIRONMENT AND SOCIAL ISSUES

2.1 Environment Issues

The project is not anticipated to have adverse significant or irreversible negative environmental impacts neither during the construction phase, nor at operation phase. Impacts of the construction phase will be typical for all medium scale construction activities, short-term/ temporary and limited to the project site. The sub-project shall be executed by demolition of the remains of existing structure declared unsafe. No Impacts small, medium or large scale shall be encountered during the operation phase as the same comprises of academic activity only. There are no sensitive areas like specially protected areas or threatened or endangered endemic species in or near the sub project area.

2.2 Social Issues

2.2.1 Availability of land

The proposed sub-project does not involve any land acquisition. As per the revenue record the sub-project is proposed on the government land on khasra number 1859 which is under the ownership of school (Appendix II). Footnotes given on the translated revenue documents shows that on Khasra number 1859-min Government High School Dogripora exists which is encumbrance free and there is no issue/dispute in the village. The school premise is provided with boundary walls from all sides & is free from any encroachment.

2.2.2 Issues of Livelihood

None will suffer adverse impact on the livelihood resources. Since school building is proposed inside the existing school, there is no impact of any commercial establishment or anything associated with livelihood.

Positive impacts will be anticipated in terms of employment opportunity as many skilled, semi skilled and un-skilled personnel will get direct and indirect employment during construction phase.

Therefore, based on the findings during survey, there are no adverse significant environmental as well as social impacts in sub-project area, hence, no further, special study or detailed Environmental Impact Assessment (EIA)/ Social Impact Assessment (SIA) needs to be undertaken.

3. PUBLIC CONSULTATION

In compliance with the World Bank's guidelines, meaningful public consultations were undertaken during the site visits in the sub-project areas on 08-09-2018 and thereafter on 27/06/2020. It was disclosed by people during consultation that none does cultivation inside the school premises and site is encumbrance free. Different stakeholders of the subproject such as teachers, students, villagers, revenue officials and others who are directly or indirectly involved with the sub-project were informed about the proposed activities and their views were obtained (Appendix-III).

3.1 Issues discussed

- Need of the subproject.
- Current facilities.
- Project and its source of assistance i.e. World Bank. Its implementation /execution etc.
- Proposed proposal for sub project
- Inconveniences during construction phase with academic activities.
- Study of Environment and Social Screening requirements and Concept of ESMP.
- Mitigation measures during construction phase.
- Social and Environmental and of the World Bank.
- Protection and conservation aspects of environmental attributes.
- Grievance Redressal Mechanism for the subproject.

3.2 Outcome and suggestions

The following suggestions were received:

- Proper barricading of construction site during construction phase so that any untoward incident can be avoided in the school premises.
- That mitigation measures should be effective during construction phase.
- That those activities which cause major disturbances should be executed before or after school timing so that academic activity should not be affected.
- That site is encumbrance free.

4. ENVIRONMENTAL & SOCIAL MANAGEMENT PLAN

A detailed Environmental and social Management Plan (ESMP) will provide specific actions deemed necessary to assist in mitigating the environmental impacts, guide the

environmentally-sound execution of the subproject, and ensure efficient lines of communication between the implementing agency, project management unit, and contractors. The ESMPs will form part of the bid document and to be reviewed during implementation. The ESMP will be included in the contractual clauses and will be made binding on the contracting firm.

PW (R&B) department, Kashmir (PIU) implementing agency ensured that the requisite environmental mitigation measures shall be incorporated in ESMP and public consultation shall be a regular process during all stages of the sub -project to solve any issues arising out of the proposed works.

Appendix-I: Environment and Social Screening

Part A: General Information

Name of the sub-project	Construction of 04 roomed block with separate toilet block for boys and girls at Govt. High, school, Dogripora, Pulwama, J and K, India	
2. Type of proposed activity (tick the applicable option and provide details)		
▪ Road	X	
▪ Bridge	X	
▪ Fire Station	X	-
▪ Hospital/Health Facility	X	
▪ Educational Institute	✓	Govt. High School, Dogripora
▪ Building for Livelihoods	X	
▪ Flood Infrastructure Related	X	
▪ Other Public Building	X	
▪ Any Other (Please Specify)	X	
3. Location of the proposed sub-project		
▪ Name of the Region	Jammu/Kashmir	
▪ Name of the District	Pulwama	
▪ Name of the Block	Pulwama	
▪ Name of the Settlement	Dogripora	
▪ Latitude	33 ⁰ 51' 39//N	
▪ Longitude	75 ⁰ 02' 37//E	
4a. Proposed Nature of Work (tick the applicable options)		
▪ Minor Repairs	X	
▪ Major Repairs/Rehabilitation	X	

▪ Upgrading/Major Improvement	X
▪ Expansion of the facility	X
▪ New Construction	✓
▪ Any Other	X
4b. Size of the sub-project (approx. area in sq. mt/hac or length in mt/km, as relevant)	323.21 sq.m class room block 36sq.m toilet block (361 sq.m)
5. Land Requirement (in hac./sq.mt.)	
▪ Total Requirement	361 sq.m
▪ Private Land	Not required
▪ Govt. Land	Available
▪ Forest Land	Not required
6. Implementing Agency Details (sub-project level)	
▪ Name of the Department/Agency	PW(R&B) Deptt. Kashmir
▪ Name of the contact person	Mr. Abdul Qayoom Kirmani
▪ Designation	Superintending Engineer
▪ Contact Number	9419951666
▪ E-mail Id	sernbcpr@gmail.com
7. Screening Exercise Details	
▪ Date on which it was carried out	08-09-2018
▪ Name of the Person	Mr. Kaiser Rafiq
▪ Contact Number	8713927709 / 7006382221
▪ E-mail Id	rafiq.kaiser@yahoo.com

Part B (1): Environment Screening

Question	Yes	No	Details
1. Is the sub-project located in whole or part within 1 km of the following environmentally sensitive areas?			
a. Biosphere Reserve		No	

b. National Park		No	
c. Wildlife/Bird Sanctuary		No	
d. Wildlife/Bird Reserve		No	
e. Important Bird Areas (IBAs)		No	
f. Habitat of migratory birds (outside protected areas)		No	.
g. Breeding/Foraging/Migratory route of Wild Animals (outside protected areas)		No	
h. Area with threatened/rare/ endangered fauna (outside protected areas)		No	
i. Area with threatened/rare/ endangered flora (outside protected areas)		No	
j. Reserved/Protected Forest		No	
k. Other category of Forest		No	
l. Wetland		No	.
m. Natural Lakes		No	
n. Rivers/Streams	Yes		River Jehlum flows adjacent to the school
o. Swamps/Mudflats		No	
p. Zoological Park		No	
q. Botanical Garden		No	
4. Is the sub-project located in whole or part within 500 mts. of any of the following sensitive features?			
a. World Heritage Sites		No	
b. Archaeological monuments/ sites (under ASI's central/state list)		No	

c. Historic Places/Monuments/ Buildings/Other Assets (not listed under ASI list but considered locally important or carry a sentimental value)		NO	
d. Religious Places (regionally or locally important)		No	
e. Reservoirs/Dams		No	
f. Canals		No	
g. Public Water Supply Areas from Rivers/Surface Water Bodies/Ground Water Sources		No	
4. What is the High Flood Level in the sub-project area?	34.70 Guage in feets,115218 cusec discharge at Sangam. HFL of 08 feet from the ground level was recorded within the school premises		
5. Is any scheduled/protected tree like Chinar, Mulberry or Deodar likely to be affected/ cut due to the project?		No	
6. Is the sub-project located in a landslide/heavy erosion prone area or affected by such a problem?		No	
7. Is sub-project located in an area that faces water paucity or water quality issues?		No	

Part B (2) : Result/Outcome of Environmental Screening Exercise		
1.	Environment Impact Assessment Required	No
2.	Environment Clearance Required	No
3.	Forest land Clearance/Diversion Required	No

4.	Tree Cutting Permission Required	No
5.	ASI (Centre/State) Permission Required	No
6.	Permission from ULB/Local Body/Department Required	Yes Permission for building construction will be required from Town Area Committee
7.	Any other clearance/permission required	Yes Various Statutory clearances and NOC's / PUC's for establishment or operation of stone crushers, generators, vehicles etc shall be required to be obtained by the Contractor from the concerned authorities. Construction material will be procured only from permitted sites and licensed /authorized quarries/ borrow sites.

Part C (1): Social Screening

1. Does the sub-project activity require acquisition of land?			
Yes		No	✓
Give the following details:	Private Land (sq mts/hac.)		No
	Govt. Land (sq mts/hac.)		361 sqm (available)
	Forest Land (sq mts/hac.)		No
2. Does the proposed sub-project activity result in demolition/removal of existing structures?			
Yes		No	✓
If so, give the following details:			
▪ Number of public structures/buildings		Nil	
▪ Number of common property resources (such as religious/cultural/ drinking water/wells/etc.)		-	

▪ Number of private structures (located on private or public land)	-		
3. Does the proposed project activity result in loss of crops/trees?			
Yes		No	✓
4. Does the proposed Project activity result in loss of direct livelihood/ employment?			
Yes		No	✓
5. Does the proposed activity result in loss of community forest/pastures on which nearby residents/local population are dependent?			
Yes		No	✓
If yes, give the details of the extent of area to be lost (in acres/hac).			
6. Does the proposed Project activity affect scheduled tribe/caste communities?			
Yes		No	✓

Part C (2): Result/Outcome of Social Screening Exercise

S.No.	Result/Outcome	Outcome
1.	Answer to all the questions is 'No' and only forest land is being acquired	NA
2.	Answer to any question is 'Yes' and the sub-project does not affect more than 200 people (i.e. either complete or partial loss of assets and/or livelihood)	No
3.	Answer to any question is 'Yes' and the sub-project affects more than 200 people (i.e. either complete or partial loss of assets and/or livelihood)	No

Outcome

The proposed sub-project will not have any significant environmental & social impact. There may be some short term inconvenience to Staff, students and local citizens due to construction but it will be for very short period if comparing with the long term benefits to the public. To address the same, ESMP will be implemented during construction.

No EIA and SIA is required for the subproject site. However, the subproject would require preparation of ESMP.

Statutory Clearances/ No Objection Certificate

Only Statutory clearances and NOC's / PUC's for establishment/operation of stone crushers, generators, vehicles etc shall be required to be obtained by the Contractor.

Appendix-II: Revenue Record

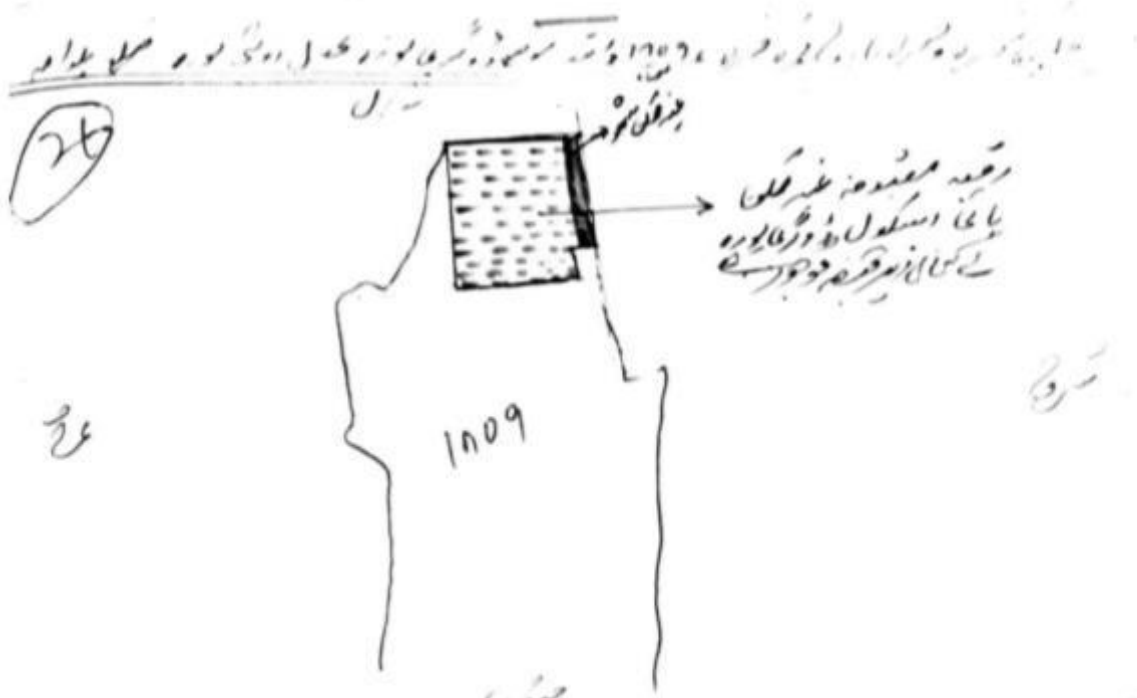

1	2	3	4	5	6	7	8
تاریخ	نام ملک و احوال	نام ملک و احوال	رقبہ	رقبہ	رقبہ	رقبہ	رقبہ
1709	مفروضہ غیر ملکی باقی اسٹیکول ڈیوٹی کے لئے	مفروضہ غیر ملکی باقی اسٹیکول ڈیوٹی کے لئے	1709	1709	1709	1709	1709

Handwritten signatures and stamps at the bottom of the page, including a date '25-20' and various official markings.

فرد انتخاب گرداوری باموضع دوشتری پوره تحصیل اونشی پوره ضلع پورنه

۱	۲	۳	۴	۵	۶
رقبہ	رقبہ	رقبہ	رقبہ	رقبہ	رقبہ
رقبہ	رقبہ	رقبہ	رقبہ	رقبہ	رقبہ

۱	۲	۳	۴	۵	۶
۱۷۵۹	حکیم حسین	پانچ اسکول دوشتری پوره	۶	۶۱	۶
	۱۱	۱۲	۲	۱۲	۲
		۸	۸	۸	۸

(نوٹ) رقم تعداد کمال زیر فرسودہ ۱۷۵۹

د. نسل ہذا فرما کر حکم مینا با اول مرتبہ کر دی گیا ہے

۲۵

۳۰

۳۱

۳۲

۳۳

۳۴

۳۵

۳۶

۳۷

۳۸

۳۹

۴۰

۴۱

۴۲

۴۳

۴۴

۴۵

۴۶

۴۷

۴۸

۴۹

۵۰

۵۱

۵۲

۵۳

۵۴

۵۵

۵۶

۵۷

۵۸

۵۹

۶۰

۶۱

۶۲

۶۳

۶۴

۶۵

۶۶

۶۷

۶۸

۶۹

۷۰

۷۱

۷۲

۷۳

۷۴

۷۵

۷۶

۷۷

۷۸

۷۹

۸۰

۸۱

۸۲

۸۳

۸۴

۸۵

۸۶

۸۷

۸۸

۸۹

۹۰

۹۱

۹۲

۹۳

۹۴

۹۵

۹۶

۹۷

۹۸

۹۹

۱۰۰

PT. H. H. H.

Patwari Hada.

Patwari Hada.

۱۷

Patwari Hada.

Patwari Hada.

Revenue Record (in English)

GHS, DOGRIPORA
ENGLISH TRANSLATION COPY OF INTIKHABI JAMABANDI (REVENUE EXTRACTS) VILLAGE/ESTATE
DOGRIPORA, TEHSIL AWANTIPORA, DISTRICT PULWAMA

(1) Khasra No.	(2) Khasra No.	(3) Name of Surr.	(4) Name of Owner with Details	(5) Name of Cultivator with Details	(6) Means of Irrigation	(7) Khasra Nos.	(8) Total area	(9) Mutable Lagan (Tax/Lavy)	(10) Type	(11) Rate of Masia	(12) Mutations		(13) Details
											No.	Type	
	907	As per No. 1	Government High School Dogripora	Government School	As per No. 1	1859	1K 6M 74K 2M 75K 8M	-	Baghi Khushki Banjri Qadeem				
				Total Khatta		Patch 1	75K 8M						





NOTE:

1. In the land measuring 6Kanal under Khasra No. 1859-min Government High School Dogripora is existing and in the land under reference the school building and ground is existing.
2. The school supra has taken all sides in its premises.
3. The land under reference is free from all kinds of encumbrances and the school supra is having possession and there is no dispute in village to the same.
4. This revenue extracts is submitted as per the orders.

Sd/- Patwari Halqa Dogripora

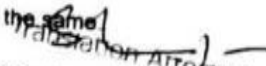
Sd/- Naib Tehsildar Awantipora

 Naib Tehsildar
 20/04/2016
 16-7

Appendix-III: Signature Sheet and Consultation Photos

FACULTY/STUDENT/GENERAL INTERACTION/CONSULTATION ATTENDANCE SLIP

Sub-Project Name: Construction of 4 roomed block and separate toilet block for boys & girls at GHS, Degrifera
 Date: 08/09/18 Venue: GHS, Degrifera

S. No.	Name With Profession	Class / Roll no / Designation / Stream	Address/Phone	Signature
1.	Eqbal-ul-Amin	9th/8	GHS, Degrifera	
2.	Anayat-Shabid	9th/17	Do	
3.	Shahid Manzoor	9th/6	do	
4.	Faizam	9th/15	do	
5.	Sakil Fayaz	9th/16	do	
6.	Yasir mehtood	9th/14	do	
7.	Fahim Rashed	9th/17	Do	
8.	Naazir Rafiq	9th/13	Do	
9.	Shaista manzoor	9th/3	Do	
10.	Arbena Rafiq	9th/4	Do	
11.	Mehvish Manzoor	9th/5	do	
12.	Iqra Gulzar	9th/2	Do	
13.	Iqra Yousuf	9th/11	Do	
14.	Fiza Shakoor	9th/10	Do	
15.	Nowreena Salam	9th/11	Do	
16.	Soby Ayoub	9th/9	Do	

FACULTY/STUDENT/GENERAL INTERACTION/CONSULTATION ATTENDANCE SHEET GHS, Dogripora

Sub-Project Name: construction of 4 classroom & separate bathroom at

Date: 27/06/2020 Venue: ~~Cyber~~ ~~Sarabera~~ Govt. High School, Dogripora.

S. No.	Name With Profession	Class / Designation/Stream	Address/Phone	Signature
i)	Mr. Ashiq Hussain Dar	Teacher	Waxipora, Dogripora 9797091403	Ashiq
ii)	Mr. Lemail Dar	occupant of Gacha - Rai	Waxipora, Dogripora 9541477016	[Signature]
iii)	Mr. Gulam Mohamud	Chinikidar - Revenue Deptt.	Waxipora, Dogripora 9596195904 9622842007	[Signature]
iv)	Abdul Gani	Farmer -	Waxipora Dogripora	[Signature]
v)	Mr. Aadil Ah. Dar	Student	- Do -	Adil
vi)	Ab. Qader Dar	Business man (occupant)	- Do -	[Signature]
vii)	Ab. Khalig Dar	Farmer (occupant)	- Do -	[Signature]

Figure 0-1: Consultation Photos
Consultation with staff and students.



Consultation with locals

