

Environmental and Social Screening Report

October: 2020

Project ID: P154990

Construction of 04 Room Classroom Block with Separate Toilet Facility for Boys and Girls at Govt. Higher Secondary School, Lalpora, (Tangmarg) Jammu and Kashmir.

Jehlum Tawi Flood Recovery Project
(World Bank Project)

Prepared by: PIU (R&B) Kashmir: Government of Jammu and Kashmir for the World Bank.

Contents

1.0	INTRODUCTION	5
1.1	Project Background.....	5
1.2	Project Development Objective.....	6
1.3	Sub-project Background.....	6
1.4	Sub-project Description	7
1.5	Objective of the Environmental and Social Screening	11
1.6	Methodology of Environment and Social Screening Study.....	11
2.0.	Environmental and Social Findings	11
2.1	Environmental Issues	11
2.2	Social Issues	12
2.2.1	Issue of Land Acquisition	12
2.2.2	Issues of Livelihood.....	12
2.2.3	Environmental and social Management Plan (ESMP)	12
3.0.	Public Consultation	13
	Appendix-A: Environment and Social Screening.....	15
	APPENDIX-B: Revenue Record (in Urdu).....	22
	Appendix-C: Signature Sheet (01.12.2018).....	24
	Appendix D: Consultation Photographs.....	26

EXECUTIVE SUMMARY

The devastating deluge of September 2014 had enormous negative impact on socio-economic aspects of the Union Territory of J&K (erstwhile State) and massive infrastructure damaged in Kashmir division of J&K. In response, a mission of the World Bank visited the Union Territory of J&K (erstwhile State) during February 1-6, 2015 in order to produce a rapid multi-sectoral assessment report of the damages and needs. The RDNA estimates the total damages and loss caused by floods at about INR 211,975 million (US\$ 3,550.45), most of it to housing, livelihoods, and roads and bridges, which combined represented more than 70% of the damages in terms of value. Public service infrastructure and equipment of hospitals and education centres were also severely damaged and are still not fully operational.

Based on the RDNA results and discussions with the GOJ&K, the “Jhelum and Tawi Flood Disaster Recovery Project (JTFRP)” will focus on restoring critical infrastructure using international best practice on resilient infrastructure. One of the sectors badly hit during the floods was education (school/college), the restorations of which have been included in the Component-1 of the World Bank investment. Under JTFRP component 1, “Construction of 04 roomed class room block with separate toilet facility for boys and girls at Govt. Higher Secondary School, Lalpora, Tangmarg”, Jammu and Kashmir was envisaged.

Government Higher Secondary School Lalpora (Tangmarg) is located in the tehsil Tangmarg of district Baramullah. The school was first established as high school in the year 1987 and was later upgraded to Higher Secondary status in the year 2007. The school has shortfall of classrooms, library and laboratories and in this connection, its reconstruction/rehabilitation has been taken under JTFRP. Presently, there are only 04 rooms in total, out of these 02 rooms are being used as classrooms, one room houses library and laboratory together and one room is being used as Principals office /staff room / administrative office. Due to short fall of class rooms and allied facilities academic and administrative work suffers.

Subprojects under “Jhelum and Tawi Flood Recovery Project” have a prior requirement of screening which is based on three categories; viz., nature of the project, size of the

project and location of the project that is sensitive area criteria. The objective of Environment and social screening is to identify the potentially significant environmental/ social issues of the sub-project at an early stage for detailed Environmental and Social impacts.

Public consultations were undertaken during the site visits in the sub-project areas on 05-11-2018. Different stakeholders i.e. teachers, people of the village were informed about the proposed sub-project and their views were obtained and mentioned in public consultation section.

The screening exercise revealed that sub-project of rehabilitation and reconstruction of damaged school is proposed inside the existing school complex. The revenue record revealed that existing school premises was constructed over 02 different khasra numbers i.e. 3361 and 3362-min. The land under khasra number 3361 was private land sold to Govt. of J&K for Government School, Lalpora by one private party whereas land under 3362- min is government land. Under khasra number 3361 land is 2 kanal and 04 Marla (1111.87 m²) and under 3362-min it is 3 kanal i.e. 1516.18 m² whereas require foer the sub-project is only 361 m². The land sold to Government School, Lalpora has been duly entered into the revenue record. Therefore, no land acquisition is required for the proposed construction.

The screening study reveals that there are no likely significant social or environmental impacts of the proposed sub-project. The sub-project does not involve any kind of land acquisition. Therefore, no further study such as SIA/EIA needs to be undertaken

1.0 INTRODUCTION

1.1 Project Background

In September 2014, J&K experienced torrential monsoon rains in the region causing major flooding and landslides. The continuous spell of rains from September 2-6, 2014, caused Jhelum and Chenab Rivers as well as many other streams/tributaries to flow above the danger mark. The Jhelum River also breached its banks flooding many low-lying areas in Kashmir, including the capital. In many districts, the rainfall exceeded the normal by over 600%. The Indian Meteorological Department (IMD) records precipitation above 244.4 mm as extremely heavy rainfall, and J&K received 558mm of rain in the June- September period, as against the normal 477.4 mm. For example, the district of Qazigund recorded over 550 mm of rainfall in 6 days as against a historic normal of 6.2 mm over the same period.

Due to the unprecedented heavy rainfall the catchment areas particularly the low lying areas were flooded for more than two weeks. Some areas in urban Srinagar stayed flooded for 28 days. Water levels were as high as 27 feet in many parts of Srinagar. The areas from the main tributaries of river Jhelum vis-à-vis Brengi nallah, Vishav nallah, Lider nallah and Sandran nallah started overflowing due to the heavy rainfall causing water levels in Jhelum river to rise. Subsequently, the discharge of the river Suran was 200 thousand cusecs as against an average of 50 thousand cusecs. With the excessive discharge of water, the river Suran affected the basin areas and also took a different course at various locations causing damages to the surrounding villages in the catchment area. Water levels also increased in the rivers of Chenab and Tawi, both of which were flowing above normal levels. Due to the rivers overflowing nearly 20 districts of the Union Territory of J&K (erstwhile State) were impacted.

A Joint team led by the Department of Economic Affairs (DEA), GoI, with representation from the World Bank visited J&K on October 21, 2014. Subsequently, GoI has sent a request to the World Bank on January 5, 2015 to field a Joint Rapid Damage and Needs Assessment (RDNA) Mission within the Union Territory of J&K (erstwhile State). In response, a mission of the World Bank visited the Union Territory of J&K (erstwhile

State) during February 1-6, 2015 in order to produce a rapid multi-sectoral assessment report of the damages and needs. The RDNA estimates the total damages and loss caused by floods at about INR 211,975 million (US\$ 3,550.45), most of it to housing, livelihoods, and roads and bridges, which combined represented more than 70% of the damages in terms of value. Public service infrastructure and equipment of hospitals and education centres were also severely damaged and are still not fully operational.

Based on the RDNA results, restoration works underway, and discussions with the GoJ&K, the project will focus on restoring critical infrastructure using international best practice on resilient infrastructure. Given the Union Territory's vulnerability to both floods and earthquakes, the infrastructure will be designed with upgraded resilient features, and will include contingency planning for future disaster events. Therefore, the project aims at both restoring essential services disrupted by the floods and improving the design standard and practices in the Union Territory of J&K (erstwhile State) to increase resilience.

The project is comprised of the following seven components:

- i. Reconstruction and strengthening of critical infrastructure (US\$60million)
- ii. Reconstruction of roads and bridges (US\$80 million)
- iii. Restoration of urban flood management infrastructure (US\$50 million)
- iv. Strengthening and restoration of livelihoods (US\$15 million)
- v. Strengthening disaster risk management capacity (US\$25 million)
- vi. Contingent Emergency Response (US\$0 million)
- vii. Implementation Support (US\$20 million)

1.2 Project Development Objective

The Project Development Objective (PDO) is to support the recovery and increase disaster resilience in targeted areas of the Union Territory of J&K (erstwhile State) and increase the capacity of the entities of Union Territory of J&K (erstwhile State) to respond promptly and effectively to an eligible crisis or emergency.

1.3 Sub-project Background

The Component-1 of the project (JTFRP) envisages the construction/reconstruction and

strengthening of critical infrastructure severely affected by the floods in September, 2014 viz., education buildings, hospitals, fire stations and other important public assets. It will include the restoration of partially damaged structures and the reconstruction of fully damaged structures, including equipment and furniture. Assessments will be carried out to determine the extent of structural integrity and retrofitting/reconstruction needs. For colleges/schools, the reconstruction will be focused on replacement of damaged buildings. The component will also finance the repair and reconstruction of damaged hospitals, higher education, fire station, and other public buildings, including the procurement of equipment/furniture, etc.

1.4 Sub-project Description

Government higher secondary school Lalpora enrolls more than 300 students and provides education for different streams viz, science, humanities etc. The school has only two single story blocks with 02 classrooms, one office and one library cum laboratory room. The class are arranged in temporary make shift shed or in open lawn due to non-availability of class rooms. Due to lack of proper infrastructure the school authorities are facing great inconvenience in conducting various education related activities / facilities.

The proposed sub project is “Construction Of 04 roomed class room block with separate toilet facility for boys and girls at Govt. Higher Secondary School, Lalpora, Tangmarg,” funded by World Bank. The Project Implementation Unit (PIU) for this sub-project will be Public Works (R&B) Department, (Kashmir) Govt. of Jammu & Kashmir.

The classroom block will accommodate 04 classrooms. Besides separate washrooms blocks will be constructed for student’s convenience with multiple cubicles. The execution of this sub-project will result in effective academic activities. The design of these blocks has taken into consideration the seismicity of the region and other factors. Planning principles and design considerations have also been reviewed and incorporated into the site planning process whenever possible. The buildings shall rest on RCC Raft / Pile foundation with plinth beams as per design. RCC Frame structure has been proposed with non load bearing panels of bricks/ hollow block (110 mm brick work and 200 mm hollow block) masonry in cement for the building. RCC slab shall be

laid over and shall be provided with steel roof truss with colour coated CGI sheets in accordance with structural design. Wooden frames of designed section shall be provided for doors, /Windows and glazed/panelled shutters wood or equivalent shall be provided in accordance with the approved architectural design. The wood work shall be painted / polished with paint of approved quality. The floor shall be of Kota/Terrazzo/ Vitrified Tiles/ Granite as per the norms freezed in CPWD cost index. All other areas including ceiling shall be cement plastered and finished with POP and emulsion paint of approved shade. The ceilings of classrooms shall be of gypsum board false ceiling. The toilets shall be provided with concealed sanitary and plumbing pipes/fittings with the requisite fixtures, chinaware etc. in accordance with the approved specifications.

Layout plan

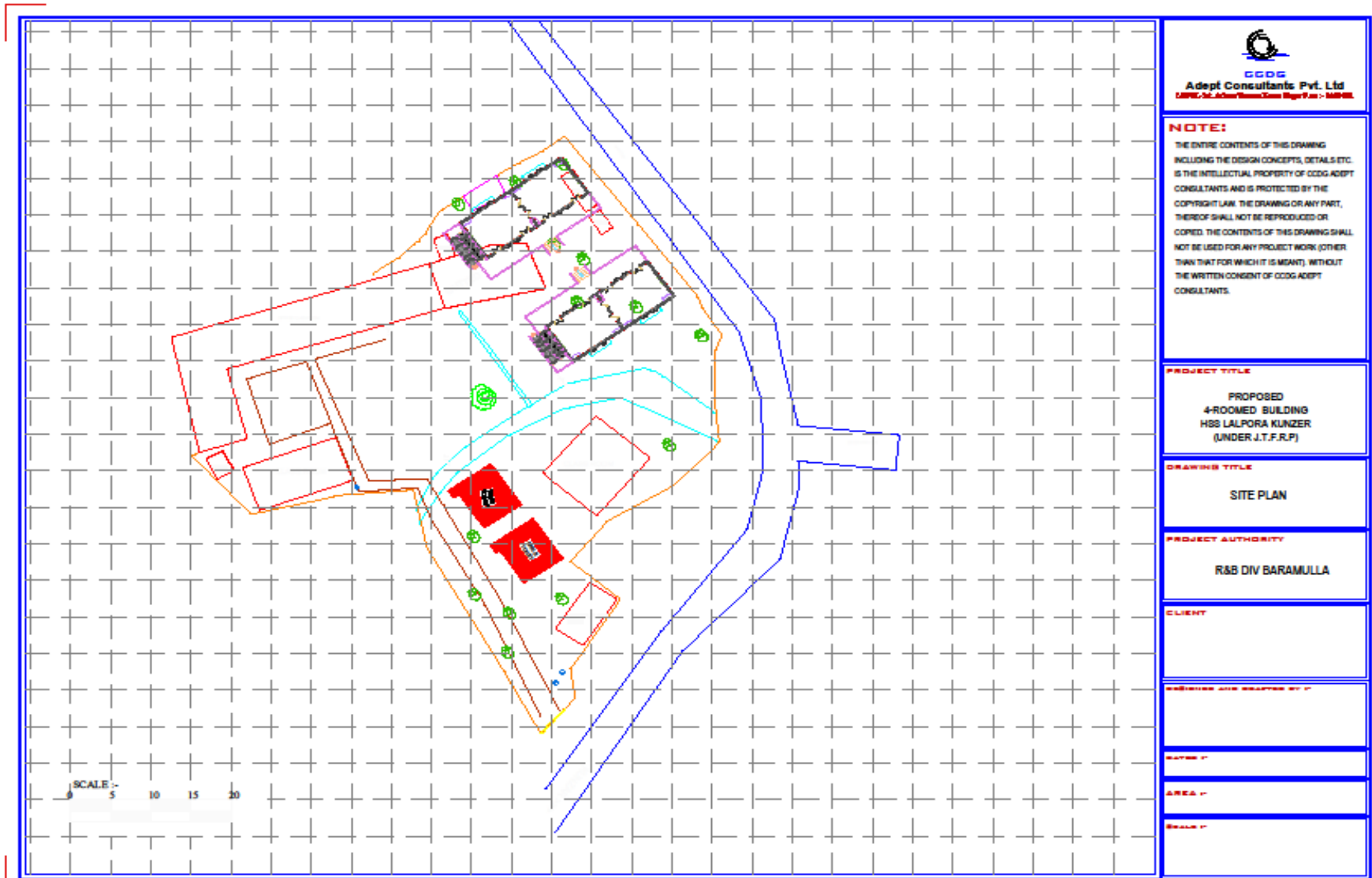

CCDC
Adept Consultants Pvt. Ltd
10/100, 2nd, Ashok/Bhawan/Chowk, Rajgurunagar - 422002

NOTE:
THE ENTIRE CONTENTS OF THIS DRAWING INCLUDING THE DESIGN CONCEPTS, DETAILS ETC. IS THE INTELLECTUAL PROPERTY OF CCDC/ADEPT CONSULTANTS AND IS PROTECTED BY THE COPYRIGHT LAW. THE DRAWING OR ANY PART, THEREOF SHALL NOT BE REPRODUCED OR COPIED. THE CONTENTS OF THIS DRAWING SHALL NOT BE USED FOR ANY PROJECT WORK (OTHER THAN THAT FOR WHICH IT IS MEANT), WITHOUT THE WRITTEN CONSENT OF CCDC/ADEPT CONSULTANTS.

PROJECT TITLE
PROPOSED
4-ROOMED BUILDING
HBS LALPORA KUNZER
(UNDER J.T.F.R.P)

DRAWING TITLE
SITE PLAN

PROJECT AUTHORITY
R&B DIV BARAMULLA

CLIENT

DESIGNER AND DRAWN BY :

DATUM :

AREA :

SCALE :

LAND USE PATTERN AROUND HRS LALPORA (within 1 km radii)

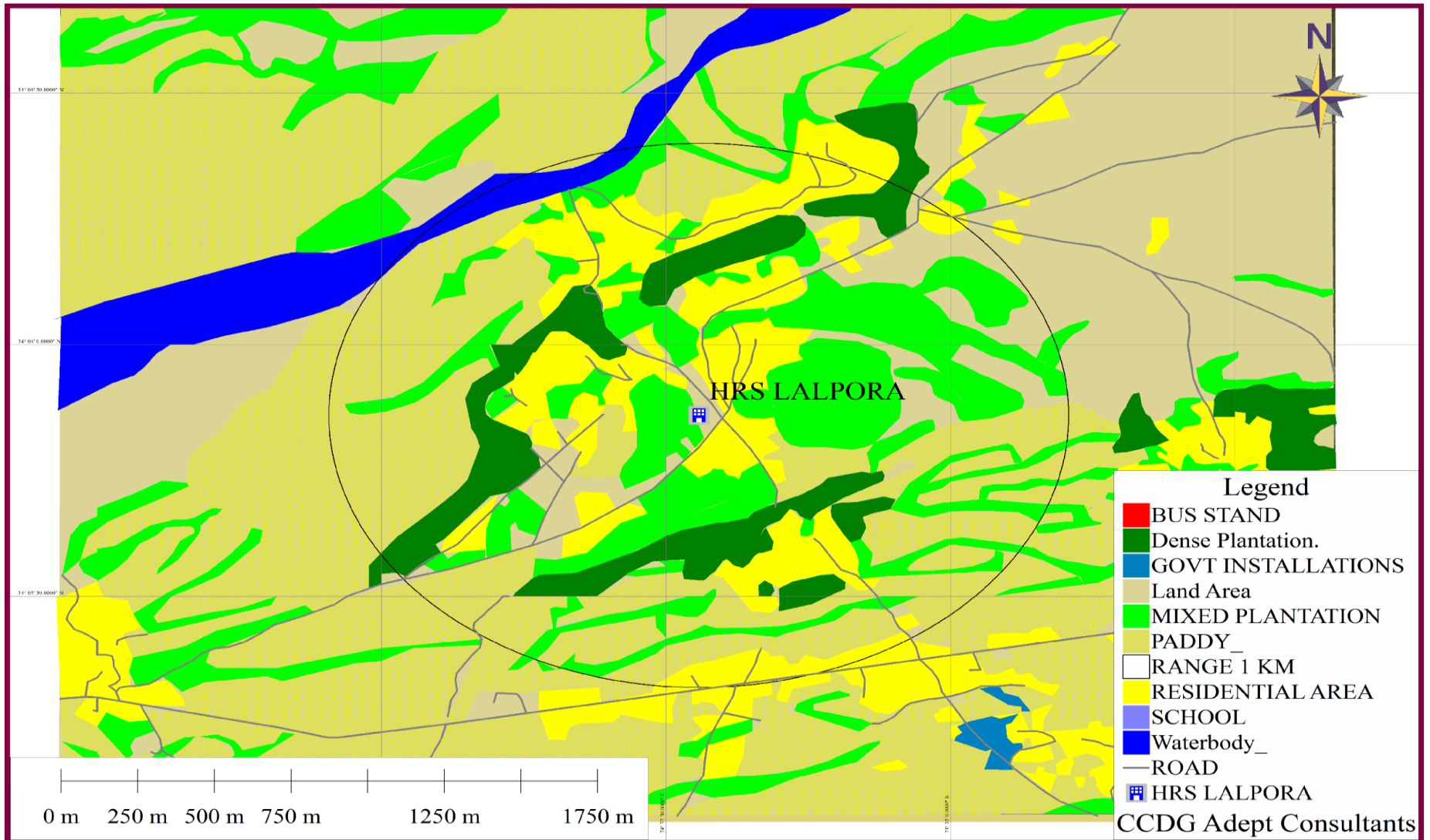

1.5 Objective of the Environmental and Social Screening

Subprojects under “Jhelum and Tawi Flood Recovery Project” commonly known as JTFRP have a prior requirement of screening which is based on three categories; viz., nature of the project, size of the project and location of the project that is sensitive area criteria. Based on this assessment, sub-projects with potentially significant environmental/ social issues are identified at an early stage for detailed Environmental/ Social impacts.

1.6 Methodology of Environment and Social Screening Study

The environment and social screening for the subproject has been carried out at the site by making use of a Environment and Social Screening Checklist (**Appendix–A**) that contains the relevant questions for identification of anticipated environment and social impacts due to execution of the subproject.

2.0. Environmental and Social Findings

2.1 Environmental Issues

The project is not anticipated to have adverse significant or irreversible negative environmental impacts neither at the construction, nor at operation phase. Impacts of the construction phase will be typical for all medium scale construction activities, short-term/ temporary and limited to the project site. Since, the proposed site is the Govt. land under existing school premises. No Impacts either small, medium or large scale shall be encountered during the operation phase as the same comprises of academic activity only. There are no sensitive areas like specially protected areas or threatened or endangered endemic species in the project area. The execution of sub-project requires cutting down of nine (09) non-scheduled trees of poplar and six (06) scheduled trees of walnut for site clearance during pre-construction phase. However plantation of new saplings in the ratio of 1:2 (2 plants for each felling tree) or more will be undertaken to compensate for the loss.

2.2 Social Issues

2.2.1 Issue of Land Acquisition

The screening exercise revealed that sub-project for rehabilitation and reconstruction of damaged school is proposed inside the existing school complex. It is evident from the revenue record that existing school premises was constructed over 02 different khasra numbers i.e. 3361 and 3362-min (Appendix B). The land under khasra number 3361 was private land sold to Govt. of J&K for Government School, Lalpora by one private party whereas land under 3362- min is government land. Under khasra number 3361 land is 2 kanal and 04 Marla (1111.87 m²) and under 3362-min it is 3 kanal i.e. 1516.18 m² whereas require for the sub-project is only 361 m². The land sold to Government School, Lalpora has been duly entered into the revenue record. Therefore, no land acquisition is required for the proposed construction.

2.2.2 Issues of Livelihood

None will have adverse impact on the livelihood and associated activities. However, positive impacts in terms of employment opportunities as many skilled, semi-skilled and un-skilled personnel will get direct and indirect employment during construction phase.

2.2.3 Environmental and social Management Plan (ESMP)

A sound, Environmental and social Management Plan (ESMP) will be prepared. It will provide specific actions deemed necessary to assist in mitigating the environmental impacts, addressing grievances of people arising out of the subproject related activities and labour management beside other requirements. ESMP will guide the environmentally-sound execution of the subproject, and ensure efficient lines of communication between the implementing agency, project management unit, and contractors. The ESMPs will form part of the bid document and to be reviewed during implementation. The ESMP will be included in the contractual clauses and will be made binding on the contracting firm.

3.0. Public Consultation

In compliance with the ESMF, public consultations were undertaken during the site visits in the sub- project areas on 05-11-2018. Different stakeholders such as teachers, villagers, students were informed about the proposed activities and their views were obtained (Appendix-C).

Issues discussed

- Need of the subproject , current facilities and proposal for sub project
- Project and its source of assistance.
- Revenue record and selling of land to Government.
- Unanticipated impacts during execution.
- Environment and Social Screening Study.
- Environmental and Social Policy of World Bank.
- Grievance Redressal Mechanism for the sub-project.

Outcome and suggestions

The following suggestions were received:

- Proper barricading of construction site during construction phase so that any untoward incident can be avoided in the school premises.
- That mitigation measures should be effective during construction phase.
- Land is encumbrance free; therefore proposed sub-project should be completed in fixed timeline.
- That those activities which cause major disturbances should be executed before and after school timing so that academic activity should not be affected.

Therefore, based on the findings during survey, there are no adverse significant environmental as well as social impacts in sub-project area, hence no further special study or detailed environmental impact assessment (EIA)/ Social impact assessment (SIA) needs to be undertaken.

PW (R&B) department as PIU/ implementing agency ensured that the requisite environmental mitigation measures shall be incorporated in ESMP and public consultation shall be a regular process during all stages of the sub -project to solve any issues arising out of the proposed works.

Appendix-A: Environment and Social Screening

Part A: General Information

1. Name of the sub-project	Construction of 04 roomed class room Block with Separate Toilet Facility for Boys and Girls at Govt. Higher Secondary School, Lalpora, Tangmarg.	
2. Type of proposed activity (tick the applicable option and provide details)		
▪ Road		
▪ Bridge		
▪ Fire Station		-
▪ Hospital/Health Facility		
▪ Educational Institute	✓	Govt. Higher Secondary School, Lalpora (Barahmullah)
▪ Building for Livelihoods		
▪ Flood Infrastructure Related		
▪ Other Public Building		
▪ Any Other (Please Specify)		
3. Location of the proposed sub-project		
▪ Name of the Region	Kashmir (J&K)	
▪ Name of the District	Baramullah	
▪ Name of the Block	Tangmarg	
▪ Name of the Settlement	Lalpora	
▪ Latitude	34° 05' 51" N	
▪ Longitude	74° 32' 33" E	
4a. Proposed Nature of Work (tick the applicable options)		
▪ Minor Repairs		

▪ Major Repairs/Rehabilitation	
▪ Upgrading/Major Improvement	
▪ Expansion of the facility	
▪ New Construction	✓
▪ Any Other	
4b. Size of the sub-project (approx. area in sq. mt/hac or length in mt/km, as relevant)	Class room block 325 sq.m Toilet block 36 sq.m
5. Land Requirement (in hac./sq.mt.)	
Total Requirement	361 sq.m
• Private Land	Not required
• Govt. Land	361 sq.m (available)
• Forest Land	Not required
6. Implementing Agency Details (sub-project level)	
▪ Name of the Department/Agency	PW(R&B) Deptt. Kashmir
▪ Name of the contact person	Mr. Abdul Qayoom Kirmani
▪ Designation	Superintending Engineer
▪ Contact Number	9419951666
▪ E-mail Id	sernbcpr@gmail.com
7. Screening Exercise Details	
▪ Date on which it was carried out	01.12.2018
▪ Name of the Person	Mr.Kaiser Rafiq
▪ Contact Number	8713927709 / 7006382221
▪ E-mail Id	rafiq.kaiser@yahoo.com

Part B (1): Environment Screening

Question	Yes	No	Details
1. Is the sub-project located in whole or part within 1 km of the following environmentally sensitive areas?			
a. Biosphere Reserve		NO	
b. National Park		NO	
c. Wildlife/Bird Sanctuary		NO	
d. Wildlife/Bird Reserve		NO	
e. Important Bird Areas (IBAs)		NO	
f. Habitat of migratory birds (outside protected areas)		NO	
g. Breeding/Foraging/Migratory route of Wild Animals (outside protected areas)		NO	
h. Area with threatened/rare/ endangered fauna (outside protected areas)		NO	
i. Area with threatened/rare/ endangered flora (outside protected areas)		NO	
j. Reserved/Protected Forest		NO	
k. Other category of Forest		NO	
l. Wetland		NO	
m. Natural Lakes		NO	
n. Rivers/Streams	YES		Ferozpur stream 500 meters away
o. Swamps/Mudflats		NO	
p. Zoological Park		NO	
q. Botanical Garden		NO	

4. Is the sub-project located in whole or part within 500 mts. of any of the following sensitive features?			
a. World Heritage Sites		NO	
b. Archaeological monuments/ sites (under ASI's central/state list)		NO	
c. Historic Places/Monuments/ Buildings/Other Assets (not listed under ASI list but considered locally important or carry a sentimental value)		NO	
d. Religious Places (regionally or locally important)		NO	
e. Reservoirs/Dams		NO	
f. Canals	YES		irrigation canal 1.5 m wide flowing through the middle of school campus
g. Public Water Supply Areas from Rivers/Surface Water Bodies/Ground Water Sources		NO	
4. What is the High Flood Level in the sub-project area?			
5. Is any scheduled/protected tree like Chinar, Mulberry or Deodar likely to be affected/ cut due to the project?	YES		SIX(06) scheduled trees of Walnut are required to cut down to clear the site for construction
6. Is the sub-project located in a landslide/heavy erosion prone area or affected by such a problem?		NO	
7. Is sub-project located in an area that faces water paucity or water quality issues?		NO	

Part B (2) : Result/Outcome of Environmental Screening Exercise		
1.	Environment Impact Assessment Required	No
2.	Environment Clearance Required	No
3.	Forest land Clearance/Diversion Required	No
4.	Tree Cutting Permission Required	YES
5.	ASI (Centre/State) Permission Required	No
6.	Permission from ULB/Local Body/Department Required	Yes Permission for building construction will be required from Town area committee.
7.	Any other clearance/permission required	Yes Various Statutory clearances and NOC's / PUC's for establishment or operation of, stone crushers, generators, vehicles etc shall be required to be obtained by the Contractor from the concerned authorities. Construction material will be procured only from permitted sites and licensed /authorized quarries/ borrow sites.

Part C (1): Social Screening

1. Does the sub-project activity require acquisition of land?			
Yes		No	√
Give the following details:	Private Land (sq mts/hac.)		No
	Govt. Land (sq mts/hac.)		361 m ²
	Forest Land (sq mts/hac.)		No
2. Does the proposed sub-project activity result in demolition/removal of existing structures?			
Yes		No	√
If so, give the following details:			
▪ Number of public structures/buildings		-	
▪ Number of common property resources (such as religious/cultural/ drinking water/wells/etc.)		-	
▪ Number of private structures (located on private or public land)		-	
3. Does the proposed project activity result in loss of crops/trees?			
Yes	√ (15 Trees)	No	
4. Does the proposed Project activity result in loss of direct livelihood/ employment?			
Yes		No	√
5. Does the proposed activity result in loss of community forest/pastures on which nearby residents/local population are dependent?			
Yes		No	√

If yes, give the details of the extent of area to be lost (in acres/hac).			
6. Does the proposed Project activity affect scheduled tribe/caste communities?			
Yes		No	√

Part C (2): Result/Outcome of Social Screening Exercise

S.No.	Result/Outcome	Outcome
1.	Answer to all the questions is 'No' and only forest land is being acquired	NA
2.	Answer to any question is 'Yes' and the sub-project does not affect more than 200 people (i.e. either complete or partial loss of assets and/or livelihood)	No
3.	Answer to any question is 'Yes' and the sub-project affects more than 200 people (<i>i.e. either complete or partial loss of assets and/or livelihood</i>)	No

Outcome

The proposed sub-project does not require land acquisition. It is proposed inside existing school complex over the government land. Therefore, proposed sub-project will not have any significant environmental & social impact. Only Inconvenience to Staff, students and local citizens during construction phase is envisaged and to address the same, ESMP will be implemented during construction. No EIA and SIA studies are required for the subproject site. However, the subproject would require preparation and implementation of ESMP.

Only Statutory clearances and NOC's / PUC's for establishment/operation of stone crushers, generators, vehicles etc shall be required to be obtained by the Contractor

Revenue Record (in English)

LALPORA
ENGLISH TRANSLATION COPY OF
INTIKHAB KHASRA GIRDAWARI
VILLAGE/ESTATE LALPORA, TEHSIL KUNZAR,
DISTRICT BARAMULLA



(1) Khasra No.	(2) Name of Owner with Details	(3) Name of Cultivator with Details	(4) Area		(6) Type of Land	(7) Levy, etc.	(8) Remarks
			Kanal	Marla			
3361	Gaffar and others as per No. 15.	Syeda and Fatima shareholders vendors in favour of Government of J&K for Government School, Lalpora.	2	4	Miskan School building and lawn	15 10	—
3362-min	State (Government)	Under occupation of government/state.	3	-	Banjri Qadeem	15	—

NOTE:

The duplicate has been issued as per the orders.

Sd/- Patwari
Halqa Lalpora

SL
 Translation Attested
 on Dated 22-Jan-2019



Appendix-C: Signature Sheet (01.12.2018)

OFFICE OF THE PRINCIPAL
GOVT. HIGHER SECONDARY SCHOOL
LALPORA, KUNZER TANGMARG 193121

Ref. No. 2422/HSS Dated. 01-12-2018

Faculty in interaction / Consultant / Allowance Slip.
 Project name:- Construction of 04 Koomid
 Class room, separate toilet block at Hss Lalpora

Sno	Name of Official	Design	Residential Address Phone Number	Signature
01	Mr. Aijaz Ahmad Wami	Principal 9419386233	Ummer abad Zamkoot Syr	
02	Mr. Iftikhar Ahmad Noo	Lecturer	R/o Mameosa Patta 9906542271	
03	Mr. Kh. Mohi ud din Jan	-do-	Dobowan. Kunzer 9797133992	
04	Mr. Kh. Mohd Qurashi	-do-	Lalpora Beerwa 9596453642	
05	Mr. Nazir Ahmad Rather	-do-	Wari Para Barzil Kunzer 9419027084	
06	Mr. Sajjad Syeed Sajada	-do-	Qamar Wari Syr	
07	Mr. Riyaz Ahmad Mallar	-do-	Dobowan. Kunzer 6005043708	
08	Mr. Towseef Ahmad Saif	-do-	Sheer Para Patta	
	Mr. Abdul Majeed Parry	-do-	Badoran. Magam 9149489892	
	Mr. Javeed Ahmad Pakka	-do-	Patta Baramulla 7006917306	
	Mr. Ab. Majeed Palla	-do-	Kulhama Tangmarg 9149603358	
	Mr. Mohd Sultan Bhat	-do-	Wadwan, Budgam.	
	Mr. Mushlag Ahmed Bhat	-do-	Wari Para Tangmarg	

①

Cont on next pg.



OFFICE OF THE PRINCIPAL

GOVT. HIGHER SECONDARY SCHOOL

LALPORA, KUNZER TANGMARG 193121

Ref. No. 2422/1856

Page (15)

Dated.

32	Ms Fayaz. Ahmad Akht	Class-iv	Beeswa Badgam 9596589473	
33	Ms Fayaz. Ahmad Wani	-Do-	Shesabad Khore Patta 9906518430	
34	Mr Do. Rashid Gamaie	-Do-	Malpora Kunzer 9484251473	
35	Mrs Nayeema Akht	-Do-	Shesabad Patta 9906597551	
36	Mr. Ghulam Ali Wani	-Do-	Qund Khaya Qasim Patta 7298452781	
37	Mr. Mohd Akhter Mir	-Do-	Hasda Bari Kunzer 9596542576	



Appendix D: Consultation Photographs

