

# Environment and Social Screening Report

---

**September: 2020**

**Project ID: P154990**

Construction of 2 Room Classroom Block at Govt. Middle School, Rakhi Litter, Pulwama Jammu and Kashmir.

(Jhelum & Tawi Flood Recovery Project)

**Prepared by PW (R&B) Department Kashmir:** Government of Jammu & Kashmir for the World Bank.

## Table of Contents

1	Introduction.....	6
1.1	Project Background .....	6
1.2	Project Development Objective .....	6
1.3	Sub-project Background .....	7
1.4	Sub-project Description .....	7
1.5	Objective of the Environmental and Social Screening.....	11
1.6	Methodology of Environment and Social Screening Study.....	11
2	Environment and Social Findings .....	11
2.1.	Environment Issues .....	11
2.2.	Social Issues.....	12
2.1.1	Issue of land acquisition .....	12
2.1.2	Issue of livelihood.....	13
2.1.3	Environmental and social Management Plan.....	13
3	Public Consultation .....	13
	Appendix-A: Environment and Social Screening.....	16
	Appendix-B: Revenue Record (in Urdu).....	23
	Appendix C: Public Consultation (08.09.2018) .....	27
	Appendix-D: NOC/Declaration from Lambardar (27.06.2020).....	28
	Appendix E: Public Consultation (26.06.2020) .....	30
	Appendix F: Community Resolution (21.09.2020).....	32
	Appendix H: Consultation Photographs (27.06.2020) .....	33
	Appendix I: Consultation Photographs (21.09.2020).....	34

## EXECUTIVE SUMMARY

The devastating floods of September 2014 show negative impact on the socio-economic aspects of the Union Territory of J&K and massive infrastructure damages in Kashmir Valley. In response, a mission of the World Bank visited the Union Territory of J&K during February 1-6, 2015 in order to produce a rapid multi-sectoral assessment report of the damages and needs. The RDNA estimates the total damages and loss caused by floods at about INR 211,975 million (US\$ 3,550.45), most of it to housing, livelihoods, and roads and bridges, which combined represented more than 70% of the damages in terms of value. Public service infrastructure and equipment of hospitals and education centers were also severely damaged and are still not fully operational.

Based on the RDNA results and discussions with the GOJ&K, the “Jhelum and Tawi Flood Disaster Recovery Project (JTFRP)” will focus on restoring critical infrastructure using international best practice on resilient infrastructure. One of the sectors badly hit during the floods was education (school/college), the restorations of which have been included in the Component-1 of the World Bank investment. Under JTFRP component-1, “Construction of 02 room single story building with separate toilet block for boys and girls at Govt. Middle school, Rakhi Litter, Pulwama has been proposed. A proposal in this regard for the said subproject was finalized and included in Jhelum and Tawi Flood Recovery Project (JTFRP).

Govt. Middle school, Rakhi Litter, Pulwama, Jammu and Kashmir, India was also affected by the floods due to its proximity with Rambiar stream a tributary of river Jhelum. The flood water severely damaged most of the existing structures thus making them unsafe to undertake academic or administrative works. With no other option the school authorities are compelled to take class work in same unsafe building. The school enrolls 150 students of both genders. The school lacks basic facilities like class rooms, reading room, and washrooms for girls etc.

Subprojects under “Jhelum and Tawi Flood Recovery Project” commonly known as JTFRP have a prior requirement of screening which is based on three categories; viz., nature of the project, size of the project and location of the project that is sensitive area

criteria. The objective of Environment and social screening is to identify the potentially significant environmental / social issues of the sub-project at an early stage for detailed Environmental and Social impacts.

The proposed sub-project does not require any land acquisition as it is being proposed inside the existing school premises. The existing school was constructed in 1984. As per the land record, the existing school was constructed over 'Shamilat Deh' i.e. common land under khasra number 694. Since the school building under JTFRP is proposed inside the existing school, therefore, it can be said that it's proposed upon the Shamilat Deh i.e. common land. The total land under khasra number 694 is 12 kanal i.e. 6064.71 m<sup>2</sup>. Out 12 kanal of land, 3 kanal (1516.18 m<sup>2</sup>) is under possession of school.

Public consultations were undertaken during the site visits in the sub- project areas on 08-09-2018 and 26-06-2020 and thereafter on 21.09.2020. Primary Stakeholder's i.e. school teachers, students, community members were informed about the proposed sub-project and their views were obtained. Since the land as per revenue record is 'Shamilat Deh' i.e. common village land, and the Gram Panchayat is non-functional, an NOC was obtained from Lambardar (Nambardar)<sup>1</sup> on 27.06.2020 for use of community land along with Minutes of meeting dated 26.06.2020. In order to bring more clarity and wider public outreach, another round of public consultation was held on September, 21, 2020; the issue of Shamailat Deh land and holding of Gram Sabha was discussed with the community. During the consultation, the community reiterated that the Panchayat is not functional, therefore, the NOC or any document provided by the Lambardar, under his seal and signature, are acceptable to them and community has no objection to the sub-project.

---

<sup>1</sup> In revenue terminology, it means Village Headman. As per J&K Lambardai Act 1980: A person shall not be qualified to be elected or appointed as Lambardar, if the person is under 30 years of age; is an employee of the government or local body; is not tilling the land; is of unsound mind, is a person who has been convicted of any offence, is of bad character involving moral turpitude. Lambardar can be elected, appointed and nominated depends upon the circumstances. Major duties of Lambardar: A Lambardar shall report to the Tehsildar about all the encroachments on common lands including roads, grazing grounds or government lands and damage to the Government property such as electric transmission lines etc; assist in such a manner as the revenue officer, may from time to time direct in crop inspection mutation proceedings, survey, preparation of records or other revenue department business within the limits of constituency; report to the Tehsildar or any concerned officer about any extra-ordinary event of public importance.

The screening study reveals that there are no likely significant social or environmental impacts of the proposed sub-project. The project does not involve any kind of land acquisition or resettlement. Therefore, no further study such as SIA/EIA needs to be undertaken.

# **1 Introduction**

## **1.1 Project Background**

In September 2014, J&K experienced torrential monsoon rains in the region causing major flooding and landslides. The continuous spell of rains from September 2-6, 2014, caused Jhelum and Chenab Rivers as well as many other streams/tributaries to flow above the danger mark. The Jhelum River also breached its banks flooding many low-lying areas in Kashmir, including the capital. In many districts, the rainfall exceeded the normal by over 600%. Due to the unprecedented heavy rainfall the catchment areas particularly the low lying areas were flooded for more than two weeks. Some areas in Kashmir and in urban Srinagar and Anantnag stayed flooded for 28 days. Water levels were as high as 27 feet in many parts of Srinagar.

Based on the **Rapid Damage Needs Assessment (RDNA)** results, restoration works underway, and discussions with the GoJ&K, the project will focus on restoring critical infrastructure using international best practice on resilient infrastructure. Given the Union Territory of J&K's vulnerability to both floods and earthquakes, the infrastructure will be designed with upgraded resilient features, and will include contingency planning for future disaster events. Therefore, the project aims at both restoring essential services disrupted by the floods and improving the design standard and practices in the Union Territory of J&K to increase resilience.

## **1.2 Project Development Objective**

The Project Development Objective (PDO) is to support the recovery and increase disaster resilience in targeted areas of the Union Territory of J&K, and increase the capacity of the entities of the Union Territory of J&K to respond promptly and effectively to an eligible crisis or emergency.

The project is comprised of the following seven components:

- I. Reconstruction and strengthening of critical infrastructure (US\$60 million)
- II. Reconstruction of roads and bridges (US\$80 million)
- III. Restoration of urban flood management infrastructure (US\$50 million)
- IV. Strengthening and restoration of livelihoods (US\$15 million)
- V. Strengthening disaster risk management capacity (US\$25 million)

- VI. Contingent Emergency Response (US\$0 million)
- VII. Implementation Support (US\$20 million)

### **1.3 Sub-project Background**

The objective of this component of the “Jhelum and Tawi Flood Recovery Project” is to support the reconstruction/restoration of damaged public buildings, such as schools, higher education buildings, hospitals, fire stations, and selected block and district offices, and other important public buildings. It will include the restoration of partially damaged structures and the reconstruction of fully damaged structures, including equipment and furniture. The component will finance infrastructure and equipment damaged by the disaster, and improvements to current structures to increase resilience. Assessments will be carried out to determine the extent of structural integrity and retrofitting/reconstruction needs. For colleges/schools, the reconstruction will be focused on replacement of damaged buildings. The component will also finance the repair and reconstruction of damaged hospitals, higher education, fire station, and other public buildings, including the procurement of equipment/furniture, etc.

### **1.4 Sub-project Description**

The sub-project is located between coordinates of 33°48'41"N and longitude 75°01'10" E. The proposed sub project “Construction 02 roomed single story building with separate toilet block for boys and girls at Govt. Middle school, Rakhi Litter is funded by the World Bank. The Project Implementation Unit (PIU) for this sub-project will be Public Works (R&B) Department, (Kashmir) Govt. of Jammu & Kashmir.

The classroom block will accommodate 02 classrooms. Besides separate washrooms blocks will be constructed for student’s convenience with multiple cubicles. The execution of this sub-project will result in effective academic activities. The design of these blocks has taken into consideration the seismicity of the region and other factors. Planning principles and design considerations have also been reviewed and incorporated into the site planning process whenever possible. The building shall rest on RCC Raft / Pile foundation with plinth beams as per design. RCC Frame structure has been proposed with non-load bearing panels of bricks/ hollow block ( 110 mm brick work and 200 mm hollow block) masonry in cement for the building. RCC slab shall be

laid over and shall be provided with steel roof truss with color coated CGI sheets in accordance with structural design. Wooden frames of designed section shall be provided for doors, /Windows and glazed/panelled shutters wood or equivalent shall be provided in accordance with the approved architectural design. The wood work shall be painted / polished with paint of approved quality. The floor shall be of Kota/Terrazzo/ Vitrified Tiles/ Granite as per the norms freezed in CPWD cost index. All other areas including ceiling shall be cement plastered and finished with POP and emulsion paint of approved shade. The toilets shall be provided with concealed sanitary and plumbing pipes/fittings with the requisite fixtures, chinaware etc. in accordance with the approved specifications.



# Lay out plan



**CCGG**  
**Adept Consultants Pvt. Ltd**  
12/113, 1st Floor, Ashoka Towers, Sector 7, Gurgaon - 122001

**NOTE:**

THE ENTIRE CONTENTS OF THIS DRAWING INCLUDING THE DESIGN CONCEPTS, DETAILS ETC. IS THE INTELLECTUAL PROPERTY OF CCGG ADEPT CONSULTANTS AND IS PROTECTED BY THE COPYRIGHT LAW. THE DRAWING OR ANY PART, THEREOF SHALL NOT BE REPRODUCED OR COPIED. THE CONTENTS OF THIS DRAWING SHALL NOT BE USED FOR ANY PROJECT WORK (OTHER THAN THAT FOR WHICH IT IS MEANT), WITHOUT THE WRITTEN CONSENT OF CCGG ADEPT CONSULTANTS.

**PROJECT TITLE**

PROPOSED  
 2-ROOMED BUILDING AT  
 G.M.S RAKHI LITTER, PULWAMA  
 (UNDER J.T.F.R.P)

**DRAWING TITLE**

SITE PLAN

**PROJECT AUTHORITY**

R&B DIV. PULWAMA

**CLIENT**

**DESIGNED AND DRAFTED BY :-**

**DATED :-**

**SCALE :-**

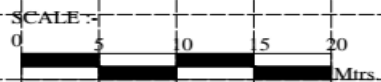
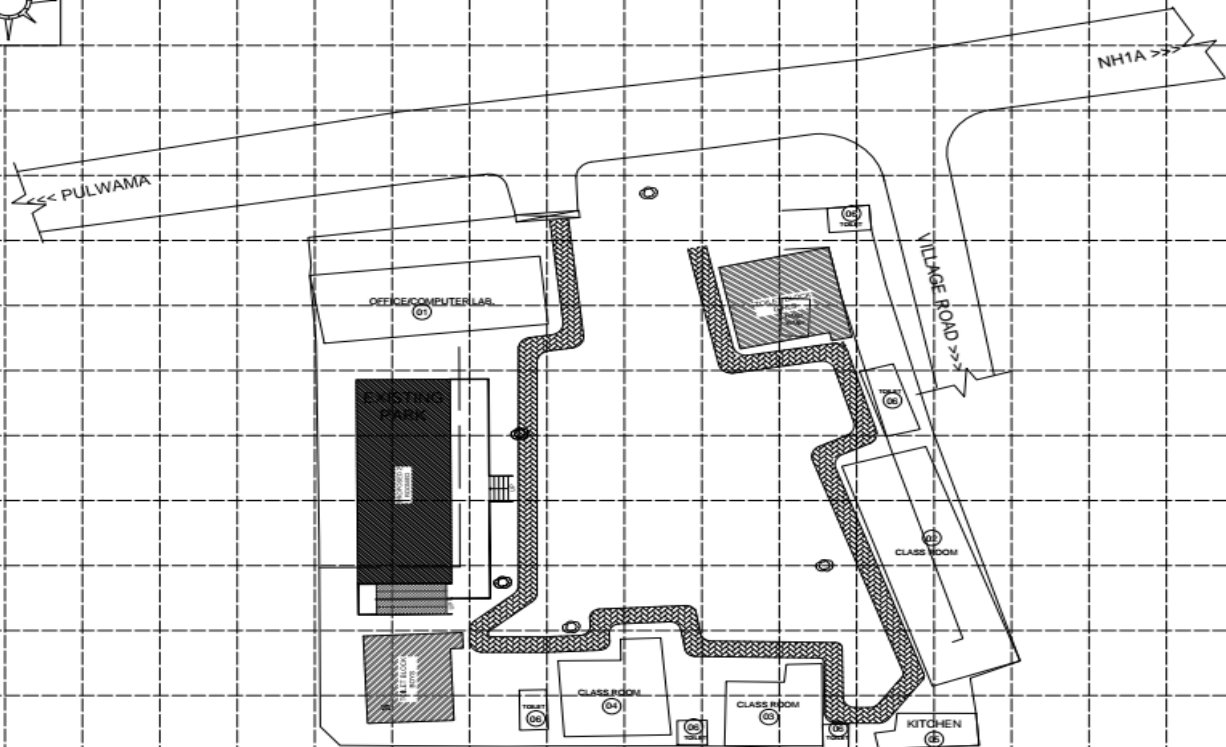
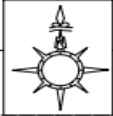

# Environmental Screening Of GMS Rakhi Litter

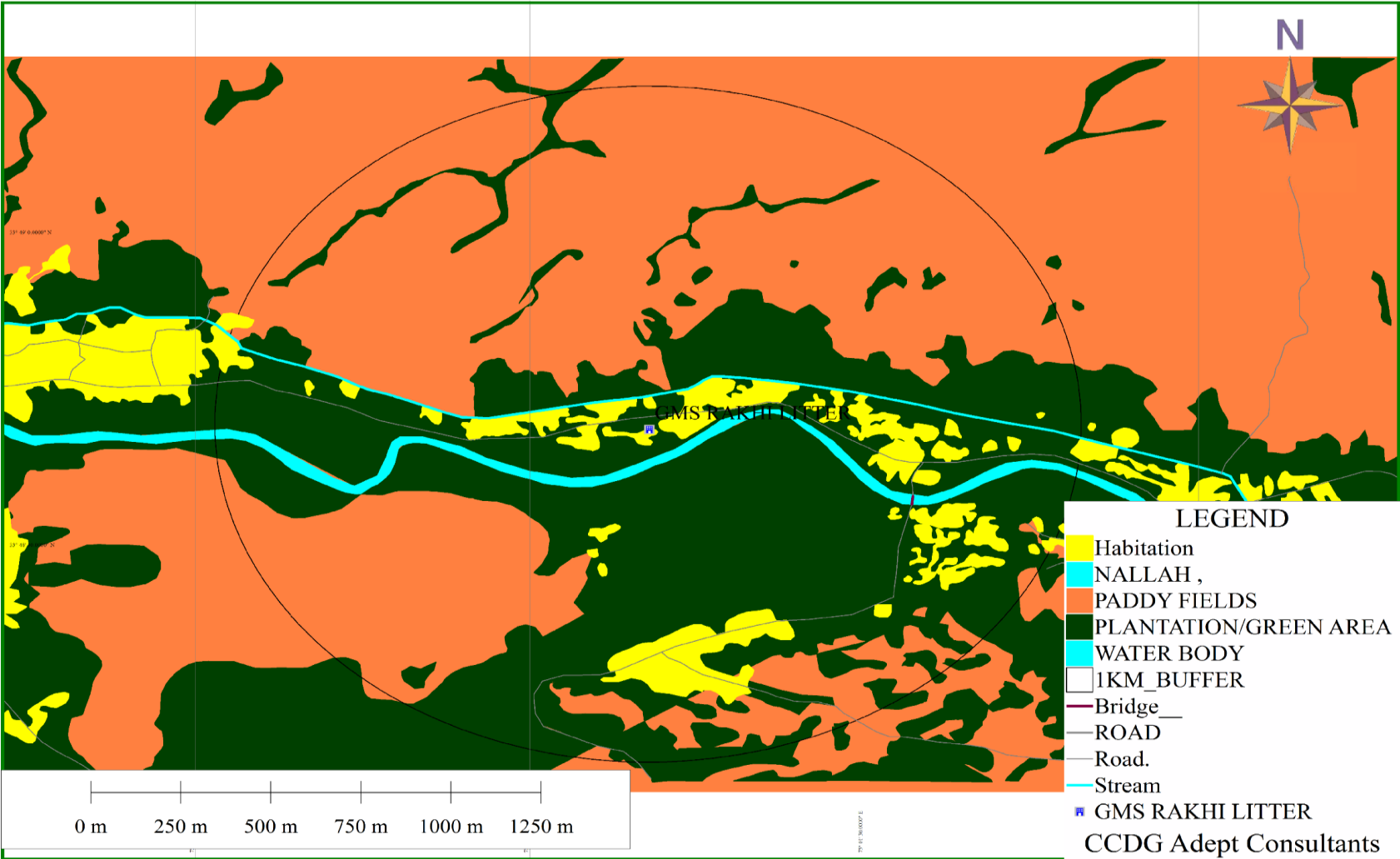

## **1.5 Objective of the Environmental and Social Screening**

Subprojects under “Jhelum and Tawi Flood Recovery Project” commonly known as JTFRP have a prior requirement of screening which is based on three categories; viz., nature of the project, size of the project and location of the project that is sensitive area criteria. Based on this assessment, sub-projects with potentially significant environmental/ social issues are identified at an early stage for detailed Environmental/ Social impacts. Evaluate all the available information on environmental and social aspects as provided in the ESDS and assess, based on the level of expected environmental and social impacts including any field visits, whether the proposed subproject is classified in different categories as per World Bank guidelines.

## **1.6 Methodology of Environment and Social Screening Study**

The environment and social screening for the subproject has been carried out at the site by making use of a Environment and Social Screening Checklist (**Appendix–A**) that contains the relevant questions for identification of anticipated environment and social impacts due to execution of the subproject.

# **2 Environment and Social Findings**

## **2.1. Environment Issues**

The project is not anticipated to have adverse significant or irreversible negative environmental impacts neither during the construction phase, nor at operation phase. Impacts of the construction phase will be typical for all medium scale construction activities, short-term/ temporary and limited to the project site. The sub-project shall be executed by demolition of the remains of existing structure declared unsafe. No Impacts small, medium or large scale shall be encountered during the operation phase as the same comprises of academic activity only. There are no sensitive areas like specially protected areas or threatened or endangered endemic species in or near the project area.

## 2.2. Social Issues

### 2.1.1 Issue of land acquisition

The proposed sub-project does not require any land acquisition as it is being proposed inside the existing school premises. The existing school was constructed in 1984. As per the land record, the existing school was constructed over 'Shamilat Deh' i.e. common land under khasra number 694 (Appendix B). Since the school building under JTFRP is proposed inside the existing school, therefore, it can be said that it's proposed upon the Shamilat Deh i.e. common land. The total land under khasra number 694 is 12 kanal i.e. 6064.71 m<sup>2</sup>. Out 12 kanal of land, 3 kanal (1516.18 m<sup>2</sup>) is under possession of school.

Since the land as per revenue record is 'Shamilat Deh' i.e. common village land, therefore, Gram Sabha (local body) was approached to obtain NOC for the use of community land for the sub-project. However, it was conveyed by the community and confirmed by the PIU as well, that holding of Gram Sabha is not feasible due to security concerns in Kashmir valley and the Gram Sabha is not functioning too. Therefore, Lambardar (Nambardar)<sup>2</sup>, of the village was approached to obtain NOC for the use of Shamilat Deh (Community) land. An NOC was issued by Lambardar on 27.06.2020 (Appendix D) and minutes of meeting (Appendix E) on 29.06.2020. However, to bring more clarity and for wider public outreach another round of consultation was conducted on September 21, 2020, with community members/villagers. During consultation, it was confirmed by the villagers that the Panchayat is not functional because last elections in their locality could not be held. They also substantiated during the consultation that the NOC provided by the Lambardar, under his seal and signature, is acceptable to them

---

<sup>2</sup> In revenue terminology, it means Village Headman. As per J&K Lambardai Act 1980: A person shall not be qualified to be elected or appointed as Lambardar, if the person is under 30 years of age; is an employee of the government or local body; is not tilling the land; is of unsound mind, is a person who has been convicted of any offence, is of bad character involving moral turpitude. Lambardar can be elected, appointed and nominated depends upon the circumstances. Major duties of Lambardar: A Lambardar shall report to the Tehsildar about all the encroachments on common lands including roads, grazing grounds or government lands and damage to the Government property such as electric transmission lines etc; assist in such a manner as the revenue officer, may from time to time direct in crop inspection mutation proceedings, survey, preparation of records or other revenue department business within the limits of constituency; report to the Tehsildar or any concerned officer about any extra-ordinary event of public importance.

and community does not have any objection to the sub-project. The passed community resolution along with the signatures of the participants is attached as Annexure F.

### **2.1.2 Issue of livelihood**

There is no adverse impact on the livelihood of anyone since the proposed sub-project is inside the premises of the existing school having proper boundary wall. No agriculture or any other activity associated with livelihood is being one the proposed site inside school premises. Positive impacts will be anticipated in terms of employment opportunity as many skilled, semi-skilled and un-skilled personnel will get direct and indirect employment during construction phase.

### **2.1.3 Environmental and social Management Plan**

A detailed Environmental and social Management Plan (ESMP) will be prepared to implement during execution. It will provide specific actions deemed necessary to assist in mitigating the environmental impacts, guide the environmentally-sound execution of the subproject, and ensure efficient lines of communication between the implementing agency, project management unit, and contractors. The ESMPs will form part of the bid document and to be reviewed during implementation. The ESMP will be included in the contractual clauses and will be made binding on the contracting firm.

## **3 Public Consultation**

In compliance with the World Banks guidelines, meaningful public consultations were undertaken during the site visits in the sub- project areas on 08-09-2018, 26.06.2020, 27-06-2020 and thereafter on 21.09.2020 (Appendix C, D, E & F). Different stakeholders of the subproject including teachers, students, and people from community were informed about the proposed activities and their views were obtained.

During consultation on Sept. 21, 2020, villagers in the presence of Lambardar confirmed that they are aware that school building under JTFRP is proposed upon the 'Shamilat Deh' land. They also substantiated that existing school inside the premises which is now being reconstructed under JTFRP, was constructed in 1984 and since then there is no claim for the land. In the resolution they also confirmed that there is no agricultural activity and no private construction by anyone and land is free of encumbrance (the

minutes of meeting and the resolution passed by the community is attached as Appendix-F). During consultation, the community reiterated that the Panchayat is not functional and therefore, the NOC provided by the Lambardar, under his seal and signature, is acceptable to them and people have no objection for the use of Community land for the school building.

### **Issues discussed**

- Need of the subproject.
- Current facilities.
- Project and its source of assistance i.e. World Bank. Its implementation /execution etc.
- Proposed proposal for sub project
- Inconveniences during construction phase with academic activities.
- Study of Environment and Social Screening requirements.
- Potential adverse impacts during execution.
- Environmental and Social Policy of World Bank.
- Use of community land for the sub-project and objection if any from the community will be considered by the project and will be further discussed.
- Grievance Redressal Mechanism for the subproject.

### **Outcome and suggestions**

The following suggestions were received:

- Proper barricading of construction site during construction phase so that any untoward incident can be avoided in the school premises.
- That mitigation measures should be effective during construction phase.
- Community has no objection for the use of 'Shamilat Deh' for the sub-project.
- That those activities which cause major disturbances should be executed before and after school timing so that academic activity should not be affected.

Therefore based on the findings during survey, there are no adverse significant environmental as well as social impacts in sub-project area, hence no further special study or detailed environmental impact assessment (EIA)/ Social impact assessment (SIA) needs to be undertaken.

PW (R&B) department as PIU/ implementing agency ensured that the requisite environmental mitigation measures shall be incorporated in ESMP and public consultation shall be a regular process during all stages of the sub -project to solve any issues arising out of the proposed works.

## Appendix-A: Environment and Social Screening

### Part A: General Information

Name of the sub-project	Construction of 02 Room Block with Separate Toilet Block for Boys and Girls at Govt Middle school, Rakhi-Litter ,Pulwama, Jammu and Kashmir, India	
<b>2. Type of proposed activity</b> (tick the applicable option and provide details)		
▪ Road	X	
▪ Bridge	X	
▪ Fire Station	X	-
▪ Hospital/Health Facility	X	
▪ Educational Institute	✓	Govt. Middle School Rakhi-Litter
▪ Building for Livelihoods	X	
▪ Flood Infrastructure Related	X	
▪ Other Public Building	X	
▪ Any Other (Please Specify)	X	
<b>3. Location of the proposed sub-project</b>		
▪ Name of the Region	Kashmir (U.T. of J&K)	
▪ Name of the District	Pulwama	
▪ Name of the Block	Pulwama	
▪ Name of the Settlement	Rakhi-Litter	
▪ Latitude	33 <sup>0</sup> 48' 41''N	
▪ Longitude	75 <sup>0</sup> 01' 10''E	



<b>4a. Proposed Nature of Work</b> (tick the applicable options)	
▪ Minor Repairs	X
▪ Major Repairs/Rehabilitation	X
▪ Upgrading/Major Improvement	X
▪ Expansion of the facility	X
▪ New Construction	✓
▪ Any Other	X
<b>4b. Size of the sub-project</b> (approx. area in sq. mt/hac or	195 sq.m class room block 36sq.m toilet block
<b>5. Land Requirement</b> (in hac./sq.mt.)	
▪ Total Requirement	231 sq.m
▪ Private Land	Not required
▪ Govt. Land	Not required
▪ Forest Land	Not required
▪ Shamilat Deh land	231 m <sup>2</sup>
<b>6. Implementing Agency Details (sub-project level)</b>	
▪ Name of the	PW(R&B) Deptt.Kashmir
▪ Name of the contact person	Mr. Abdul Qayoom Kirmani
▪ Designation	Superintending Engineer
▪ Contact Number	9419951666
▪ E-mail Id	sernbcrp@gmail.com
<b>7. Screening Exercise Details</b>	
▪ Date on which it was carried out	08-09-2018, 26.06.2020, 27.06.2020& 21.09.2020
▪ Name of the Person	Mr.Kaiser Rafiq

▪ Contact Number	8713927709 / 7006382221
▪ E-mail Id	rafiq.kaiser@yahoo.com

**Part B (1): Environment Screening**

Question	Yes	No	Details
<b>1. Is the sub-project located in whole or part within 1 km of the following environmentally sensitive areas?</b>			
a. Biosphere Reserve		No	
b. National Park		No	
c. Wildlife/Bird Sanctuary		No	
d. Wildlife/Bird Reserve		No	
e. Important Bird Areas (IBAs)		No	
f. Habitat of migratory birds (outside protected areas)		No	.
g. Breeding/Foraging/Migratory route of Wild Animals (outside protected areas)		No	
h. Area with threatened/rare/endangered fauna (outside protected areas)		No	
i. Area with threatened/rare/endangered flora (outside protected areas)		No	
j. Reserved/Protected Forest		No	
k. Other category of Forest		No	
l. Wetland		No	.
m. Natural Lakes		No	

n. Rivers/Streams	Yes		Rambir stream a tributary of river Jehlum flows adjacent to the school
o. Swamps/Mudflats		No	
p. Zoological Park		No	
q. Botanical Garden		No	
<b>4. Is the sub-project located in whole or part within 500 mts. of any of the following sensitive features?</b>			
a. World Heritage Sites		No	
b. Archaeological monuments/ sites (under ASI's central/state list)		No	
c. Historic Places/Monuments/ Buildings/Other Assets (not listed under ASI list but considered locally important or carry a sentimental value)		NO	
d. Religious Places (regionally or locally important)		No	
e. Reservoirs/Dams		No	
f. Canals		No	
g. Public Water Supply Areas from Rivers/Surface Water Bodies/Ground Water Sources		No	
4. What is the High Flood Level in the sub-project area?	34.70 Guage in feets,115218 cusec discharge at Sangam. Recorded HFL was 08 feet from ground level within school campus		
5. Is any scheduled/protected tree like Chinar, Mulberry or Deodar likely to be affected/ cut due to the project?		No	

6. Is the sub-project located in a landslide/heavy erosion prone area or affected by such a problem?		No	
7. Is sub-project located in an area that faces water paucity or water quality issues?		No	

<b>Part B (2) : Result/Outcome of Environmental Screening Exercise</b>		
1.	Environment Impact Assessment Required	No
2.	Environment Clearance Required	No
3.	Forest land Clearance/Diversion Required	No
4.	Tree Cutting Permission Required	No
5.	ASI (Centre/State) Permission Required	No
6.	Permission from ULB/Local Body/Department Required	Yes Permission for building construction will be required from Town Area Committee
7.	Any other clearance/permission required	Yes Various Statutory clearances and NOC's / PUC's for establishment or operation of stone crushers, generators, vehicles etc shall be required to be obtained by the Contractor from the concerned authorities. Construction material will be procured only from permitted sites and licensed /authorized quarries/ borrow sites.

**Part C (1): Social Screening**

<b>1. Does the sub-project activity require acquisition of land?</b>			
Yes		No	✓
Give the following details:	Private Land (sq mts/hac.)		No
	Govt. Land (sq mts/hac.)		No
	Forest Land (sq mts/hac.)		No
	Community land		231 m <sup>2</sup>
<b>2. Does the proposed sub-project activity result in demolition/removal of existing structures?</b>			
Yes		No	✓
If so, give the following details:			
▪ Number of public structures/buildings		Nil	
▪ Number of common property resources (such as religious/cultural/ drinking water/wells/etc.)		-	
▪ Number of private structures (located on private or public land)		-	
<b>3. Does the proposed project activity result in loss of crops/trees?</b>			
Yes		No	✓
<b>4. Does the proposed Project activity result in loss of direct livelihood/ employment?</b>			
Yes		No	✓
<b>5. Does the proposed activity result in loss of community forest/pastures on which nearby residents/local population are dependent?</b>			
Yes		No	✓

If yes, give the details of the extent of area to be lost (in acres/hac).			
<b>6. Does the proposed Project activity affect scheduled tribe/caste communities?</b>			
Yes		No	✓

**Part C (2): Result/Outcome of Social Screening Exercise**

S.No.	Result/Outcome	Outcome
1.	Answer to all the questions is 'No' and only forest land is being acquired	NA
2.	Answer to any question is 'Yes' and the sub-project does not affect more than 200 people (i.e. either complete or partial loss of assets and/or livelihood)	No
3.	Answer to any question is 'Yes' and the sub-project affects more than 200 people ( <i>i.e. either complete or partial loss of assets and/or livelihood</i> )	No

**Outcome**

The sub-project requires use of community land which is already under the peaceful possession of school. An NOC regarding the use of this land was obtained from Lambardar. The community raised no objection for the use of community land and accepted and reiterated the NOC given by Lambardar.

The proposed sub-project will not have any significant environmental & social impact. There may be some short term inconvenience to Staff, students and local citizens due to construction but it will be for very short period. To address the same, ESMP will be implemented during construction to mitigate any impacts.

**No EIA and SIA is required for the subproject site. However, the subproject would require preparation of ESMP.**

Only Statutory clearances and NOC's / PUC's for establishment/operation of batching plant, stone crushers, generators, vehicles etc shall be required to be obtained by the Contractor.

Appendix-B: Revenue Record (in Urdu)

مکمل شجرہ نمبر ۶۹۲۷ و ۶۹۲۸ کے لئے ۱۱۰۰ روپیہ فی ایکڑ کی شرح پر ۱۱۰۰ روپیہ  
مکمل

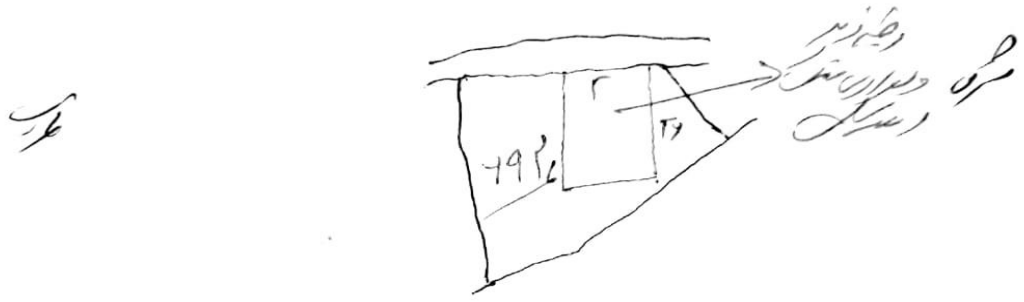

مکمل شجرہ نمبر ۶۹۲۷ و ۶۹۲۸ کے لئے ۱۱۰۰ روپیہ فی ایکڑ کی شرح پر ۱۱۰۰ روپیہ  
مکمل

۶۹۲۷

3  
 نیشنل ایجوکیشنل سروسز کے لیے مختلف شعبوں میں ملازمین کے تعیناتی ٹیسٹ کے نتائج کی فہرست

پہلا نمبر	دوسرا نمبر	تیسرا نمبر	چوتھا نمبر	پانچواں نمبر	نام و پتہ	پیداوار
12	218	12			شہادتہ خالد خان	شہادتہ خالد خان
			692		شاہدہ شکیلہ بیگم	شاہدہ شکیلہ بیگم
					ملیہ علیہ بیگم	ملیہ علیہ بیگم
					ملیہ علیہ بیگم	ملیہ علیہ بیگم
					ملیہ علیہ بیگم	ملیہ علیہ بیگم
					ملیہ علیہ بیگم	ملیہ علیہ بیگم
					ملیہ علیہ بیگم	ملیہ علیہ بیگم
					ملیہ علیہ بیگم	ملیہ علیہ بیگم
					ملیہ علیہ بیگم	ملیہ علیہ بیگم
					ملیہ علیہ بیگم	ملیہ علیہ بیگم
					ملیہ علیہ بیگم	ملیہ علیہ بیگم
					ملیہ علیہ بیگم	ملیہ علیہ بیگم

1. یہ سرکاری فہرست ہے جو اس وقت تک درست ہے جب تک اس میں کوئی تبدیلی نہیں کی جاتی۔  
 2. اس فہرست میں شامل ہونے والے امیدواروں کو اس سے متعلقہ ادارے میں ملازمت کے لیے بلاشبہ اپنا نام درج کروانے کی ضرورت ہے۔

25/11/2017  
 Tehsil Shikhan  
 20

۴۴  
 Tehsildar Shikhan  
 O.O.



(2)

نقل انتخاب گروہ اور سی با وضع اکہ لہی تحصیل شاہپورہ لکھنؤ ضلع بہار

رقبہ تعداد	رقبہ تعداد		نام صاحب حق احوال	نام صاحب حق احوال	رقبہ
	کلی	مرا			
۱	-	-	حضرہ کا جو لہی د	سیدہ لکھنؤ - ۲۰	۶۹۲
۸	-	-	//	//	
۲	-	-	//	//	
۱۳	-	-	//	//	
۱۶	-	-	//	//	

توجہ حاصل اور سی / سیدہ لکھنؤ / حضورہ کا جو لہی د

25/11/2017

Patwar Sahab

25/11/2017

Tehsildar Shahpur

O.O.

Revenue Record (in English)

**ENGLISH TRANSLATION COPY OF INTIKHABI JAMABANDI (REVENUE EXTRACTS) VILLAGE/ESTATE RAKHI LITTER, TEHSIL SHAHOORA LITTER, DISTRICT PULWAMA**

(1) Khwat No.	(2) Khasra No.	(3) Name of Surr.	(4) Name of Owner with Details	(5) Name of Cultivator with Details	(6) Means of Irrigation	(7) Khasra Nos.	(8) Total area	(9) Mutable Lagan (Tas/Levy)	(10) Type	(11) Rate of Malia	(12) Mutations		
											No.	Type	Details
27	218	As per No. 1	Shamilaat of owners except Khwat No. 19, 20, 21, 22, 23, 24, 25, 26, and Khasra Nos. 802/690, 704/303, 208, 756/709, 798/266, 255, 267, 501 under Khwat Nos. 19 to 26.	Reserved Gahcharai, Aziz and Ahad and Anwar sons of Khaliq in equal one share and Abdul and Assad and Ahmad and Ali sons of Khalil in equal four shares and Qadir and Gani sons of Khaliq and Mohammad son of Gaffar and Jamal son of Ramzan one share and Habib son of Subhan and Qadir and son of Sidiq and Qasim son of Sultan in equal shares two shares resident of village, illegal possession.	---	694	6K 6K 12K		Baghi Khushki Banjri Qadeem	As per No 194			

**NOTE:**

1. in Khasra No. 694 on spot Government Girls Middle School is constructed and existing.
2. In Khasra No. supra on spot land measuring 3 kanals school duly fenced is existing on spot.
3. The duplicate supra has been issued accordingly as per orders for onward action.

Sd/- Patwari Halqa Rakhi Litter

Sd/- Tehsildar Shahoora, Litter

SLI  
 Translation Artist  
 on Date 16-11-2021



## Appendix C: Public Consultation (08.09.2018)

### FACULTY/STUDENT/GENERAL INTERACTION/CONSULTATION ATTENDANCE SLIP

Sub-Project Name: construction of 2 roomed block with toilet facility for boys & girls at GMS, Rahbi Litter.  
 Date: 08/09/2018. Venue: GMS, Rahbi Litter.

S. No.	Name With Profession	Class / R No Designation/Stream	Address/Phone	Signature
01	Andleeb Ghulam	B.Ed R.No. 04	GMS, Rahbi Litter	Andleeb
02	Saqia Nazki	B.Ed R.No. 01	do	Saqia
03	Umer Rashid	B.Ed R.No. 03	do	Umer
04	Lubna Javid	B.Ed R.No. 11	do	Lubna
05	Muskan Gafar	T.H R.No. 01	do	Muskan
06	Onias Reza	T.H R.No. 01	do	Onias
07	Intiya Raza	T.H R.No. 07	do	Intiya
08	Abid Nisar	T.H R.No. 06	do	Abid
09	Aabir Ashraf	T.H R.No. 03	do	Aabir
08	Rohee Ashraf	T.H R.No. 04	do	Rohee
09	Shahid Razaq	T.H R.No. 05	do	Shahid
10	Shahid Mohi-Ud-Din	T.H R.No. 08	do	Shahid
11	Simran	T.H R.No. 10	do	Simran
12	Insha Nazki	T.H R.No. 12	do	Insha

# Appendix-D: NOC/Declaration from Lambardar (27.06.2020)

## Consultation Jhelum Tawi Flood Recovery Project Government of J&K

Date: 27/06/2020 Place: Ralch Litter

Name of the Subproject: Construction of 2 Classroom block at GMS Ralch Litter

Name of the PIU: R & B - Dept.

Name of the Owner/Possessor/Occupant: G.H. Mohammad Mir (Lambardar) Gender: male

Khasra no..... Type of Land.....

Address of the Owner/Possessor: Ralch Litter G.H. Mohammed Mir representing community

1. As per Revenue record land occupant : Owner/Successor/Legal heir/ Legal Representative/Nominee/Tenant/Occupant(Mark) → Lambardar representing community

2. Do you know that Government of J&K Kashmir under "Jhelum Tawi Flood Recovery Project" proposed to construct a school building over the land under your occupancy?

Yes/No

3. What is the current usage of the land?  
Under school possession with boundary wall from all sides. No encroachment or agricultural activity in place.

4. Is your livelihood dependent on the land required for proposed construction?

Yes/No

5. Do you have any objection if PIU through PMU (JFRP) under World Bank funding construct a school building over the land under your occupancy?

Yes/no

Signature

Mobile number:

Name of Officer from PIU: YASIR FAIZ JAN  
Designation: AGE  
Mobile Number: 9419006042

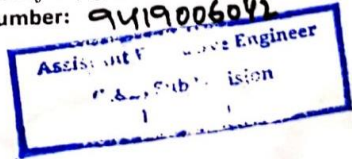

**Declaration**

I, Lambhadas ✓ Sarpanch G.H. Mohammad Mir (Name), Sarpanch Lambhadas ✓ of village Rakhi-litter  
..... Panchyat Litter R/O Rakhi-litter P/O Wachi  
...Tehsil Litter District Pulwama of Jammu & Kashmir U.T., have no objection if  
Project Implementation Unit R&B  
..... will construct School building (World Bank Funded) at Gaut. Middle  
School, Rakhi Litter for public purpose over the land under khasra number..... measuring  
(sq. ft/sqm)..... which is shamatdeh land as per revenue record and is inside the existing  
Scholl namely Gaut. Middle school Rakhi Litter premises.

Name & Signature of Sarpanch Lambhadas G.H. Mohammad Mir  
Mobile Number 9797108656  
Panchayat name.....  
Mobile number.....  
9797108656





## Appendix E: Public Consultation (26.06.2020)

### Minutes of the consultation meeting

Subproject name: Construction of 2 class room block with separate washroom  
 Location Rakhi Lites District Pulwama. block at Govt. Middle school Rakhi Lites,  
 Date 26/06/2020 Time 12:30 Pulwama.

Sl no.	Issues Raised/Discussed	Response of Participants	Remarks
1	Need of Subproject	The community welcomed the decision of undertaking the sub project under JTRP as present infrastructure do not suffice	The sub project will provide the much needed infrastructure for students
2		the present enrollment. Besides flood of 2014 have damaged the existing infrastructure beyond repair.	
3	Land ownership and community role	The community is aware of the fact that the school is on community land (Reserved Gancharia) with ownership under Khara No 694	" No issues raised by community. They welcomed the move and assured of any support in near future.
4		measuring 3kanals and with boundary wall from all sides. No occupant is having ownership with said Khara No. Noc provided by Sarpanch / Nam Sardar has been annexed. The community hailed the decision of undertaking the sub project.	

## Signature Sheet

### Public Consultation for JFRP Jammu & Kashmir

Subproject name: Construction of 2 class room block with separate washroom facility  
 Location: Rakhi Litter District: Pulwama at Govt. Middle School, Rakhi Litter, Pulwama  
 Date: 26/06/2020 Time: 11:00 AM

#### Information of Participants

Sl. No.	Name	Gender	Address	Occupation	Mobile number
1	Bashir Ah. Kullay	Male	Rakhi-Litter Shop	Shopkeeper	98191
2	Mustafa Ah. Mir	Male	- Do -	Farmer	
3	Tarig Ah. Mir	Male	- Do -	Labourer	98191
4	Azif Ahmad	Male	- Do -	Plumber	98191
5	Imtiyaz Ah. Kullay	Male	- Do -	Businessman	Imtiyaz
6	Shazia	Female	- Do -	Student	
7	Ab. Aziz	Male	- Do -	Farmer	
8	Ab. Khalig	Male	- Do -	Farmer	
9	M. Sultan	Male	- Do -	Farmer	

## Appendix F: Community Resolution (21.09.2020)

A meeting is organized today i.e. on 21/09/2020 by the villagers/community of the village Rakhi Litter of tehsil Shahora district Pulwama of J&K, where a school building under sub-projects "Construction of 2 room Classroom Block at Govt. Middle School, Rakhi Litter(Pulwama) Jammu and Kashmiris proposed. This is proposed under JTFRP (World Bank funded). The objective of the meeting is to deliberate on the revenue record, involvement of stakeholders and to obtain voluntary consent of people for the sub-project.

- The people are aware of the fact that a school building inside existing GMS Rakhi Litter is proposed under JTFRP. They are also aware that land over which the school building is proposed falls under khasra number 694 and is 'Shamilat Deh' (Common village land).
- Under Khasra number 694 a total of 12 kanalland is available. Out of which 3 kanal is under the school having proper boundary wall and fencing.
- Although revenue record shows that land is under illegal occupation. But 3 Kanal of land is occupied by none and is under the peaceful possession of GMS Rakhi Litter school. There is no agricultural or any other activity on the land identified for construction of school building. Besides, there is no construction by any private party and land is free from encumbrance.
- The school was constructed in the year 1984. Since then there is no claim for compensation or on land since it was constructed over the common village land.
- People have no objection if PIU (R&B) construct school building proposed under JTFRP (World Bank funding).
- The Panchayat (Local body) is not functional, therefore, NOC/consent or any other document provided by the Lambardar is acceptable to the community. The community has no objection to the proposed sub-project under JTFRP.

Name	Signature	Mobile number
1. Dawood Ahmad Mir		9797977141
2. Ubaid Shefi Bhat		6005209912
3. Shahid Shabir		9149544072
4. Zahoor Ahmad Mir		7780860867
5. Rafiq Hussain Ganje		8493082812
6. Basim Ah Kullay		8491841272
7. Mond Amol man		9622546209
8. Baidhan Ahmad Mir Baidhan		9906483498
9. Ab-Gani wan		962280768
10. Gul Mohd. Mir	(Lambardar)	9797108656



## Appendix H: Consultation Photographs (27.06.2020)





## Appendix I: Consultation Photographs (21.09.2020)

